

CLEVITE[®]
ENGINE PARTS

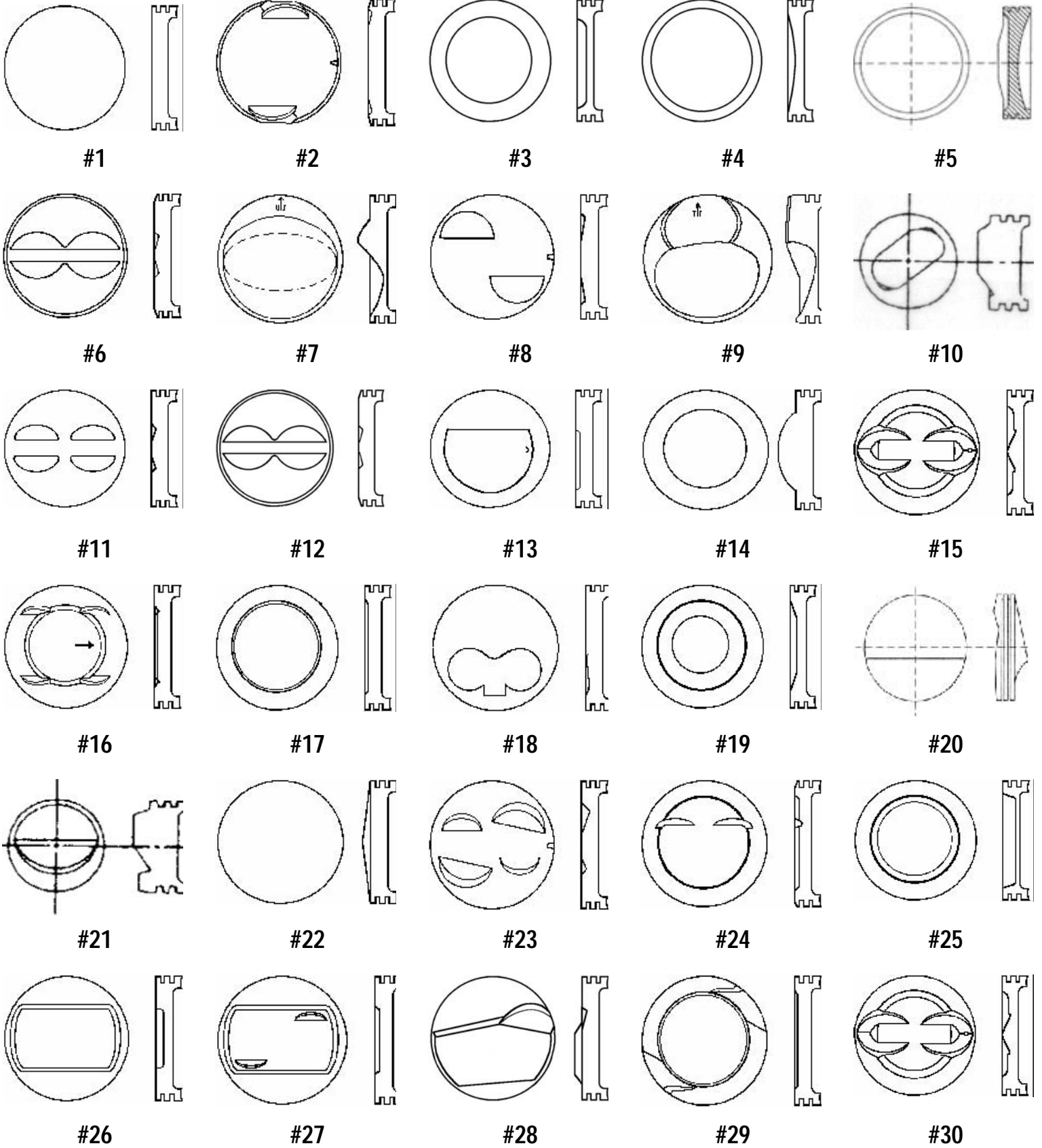

**PISTON
SPECIFICATIONS**

Head Configuration Reference Diagrams



Head Configuration Reference Diagrams

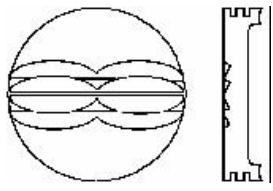

#31

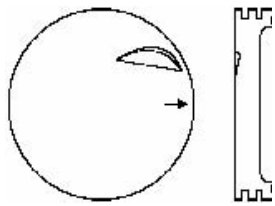

#32

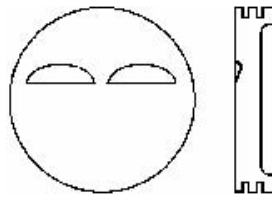

#33

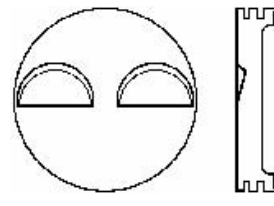

#34

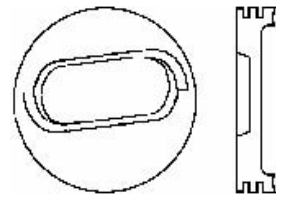

#35

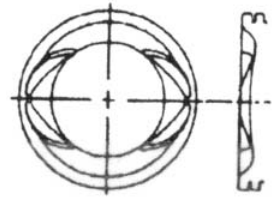

#36

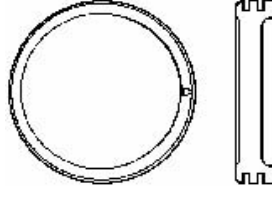

#37

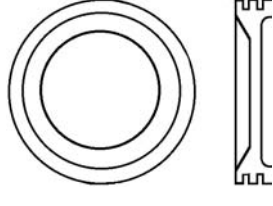

#38

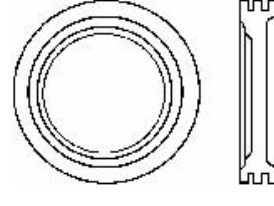

#39

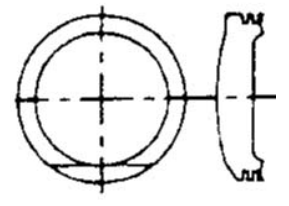

#40

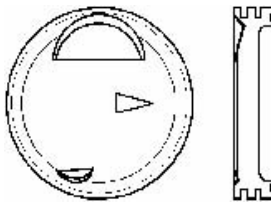

#41

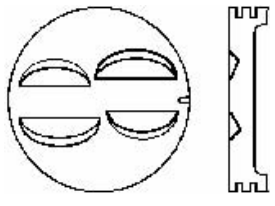

#42

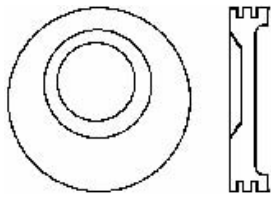

#43

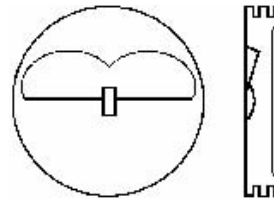

#44

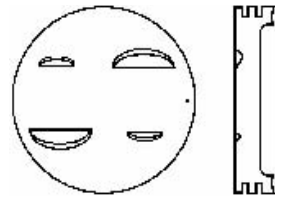

#45

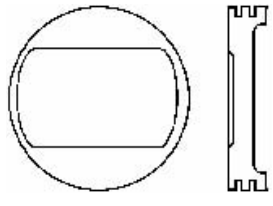

#46

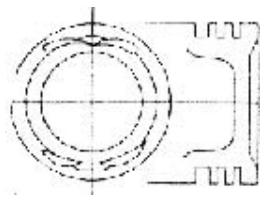

#47

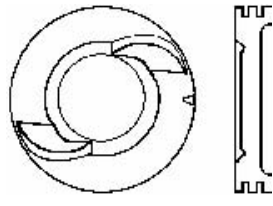

#48

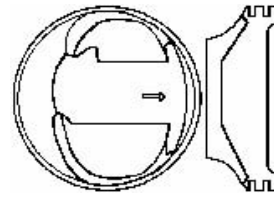

#49

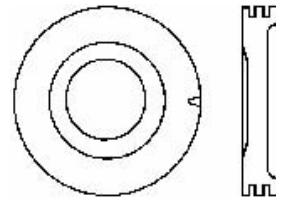

#50

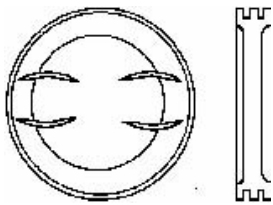

#51

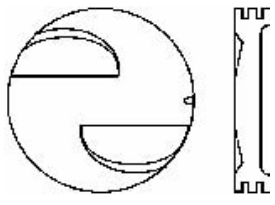

#52

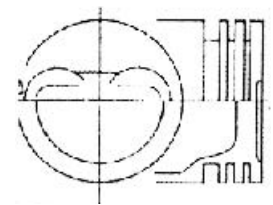

#53

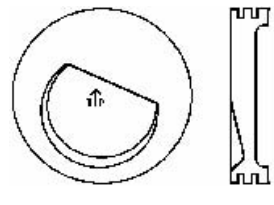

#54

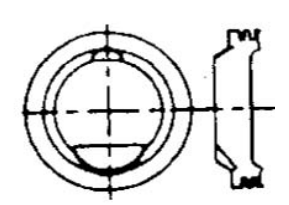

#55

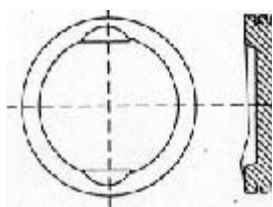

#56

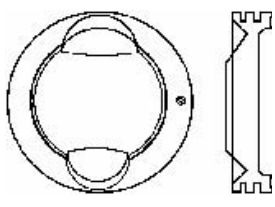

#57

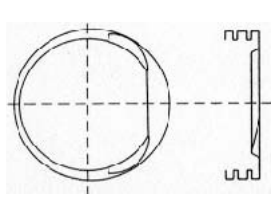

#58

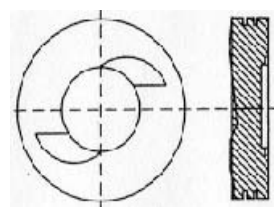

#59

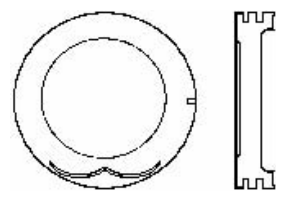

#60

Head Configuration Reference Diagrams

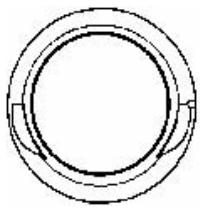

#61

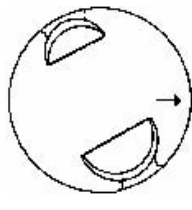

#62

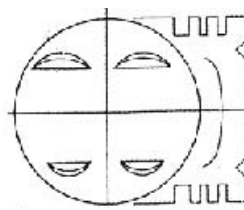

#63

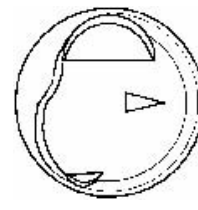

#64

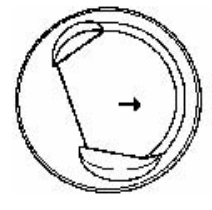

#65

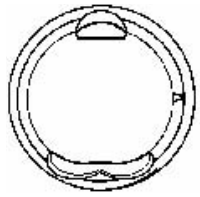

#66

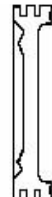
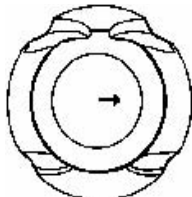

#67

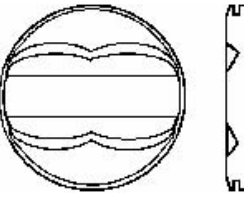

#68

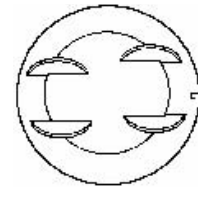

#69

no picture

#70

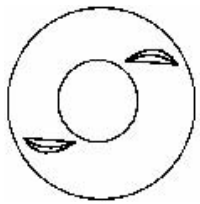

#71

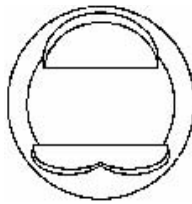

#72

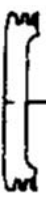
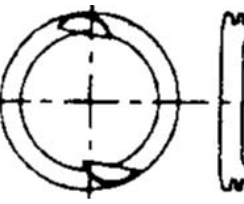

#73

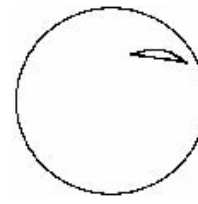

#74

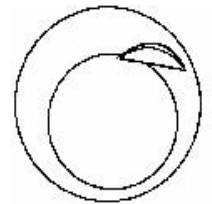

#75

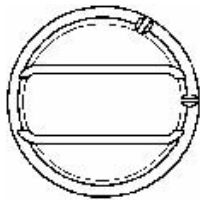

#76



#77

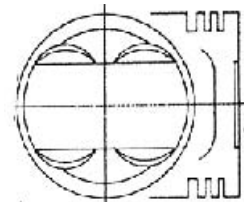

#78

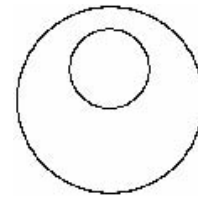

#79

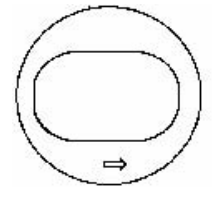

#80

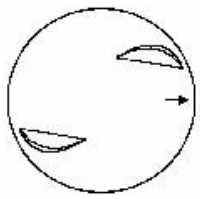

#81

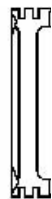
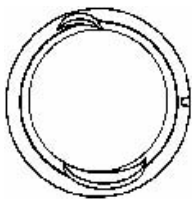

#82

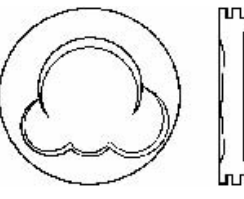

#83

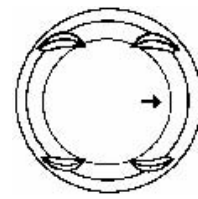

#84

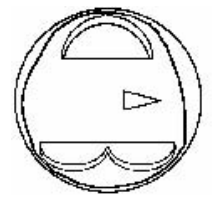

#85

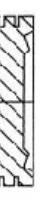
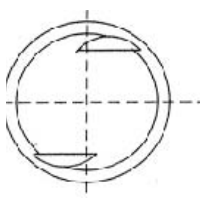

#86

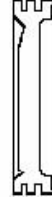
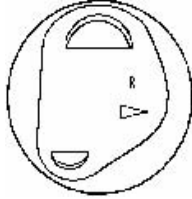

#87

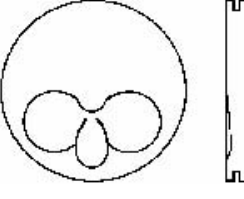

#88

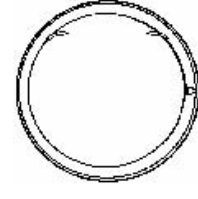

#89

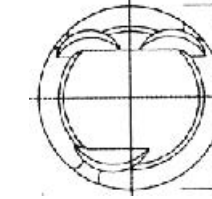

#90

Head Configuration Reference Diagrams

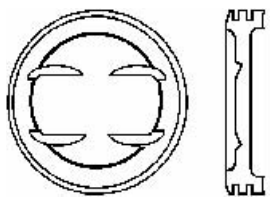

#91

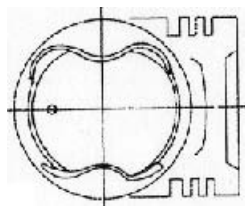

#92

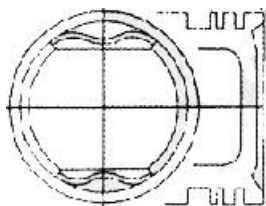

#93

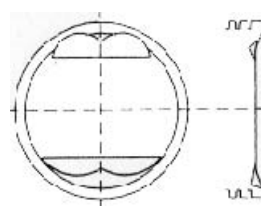

#94

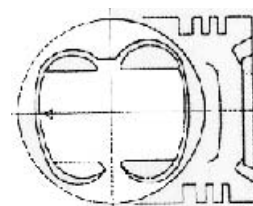

#95

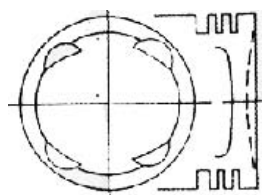

#96

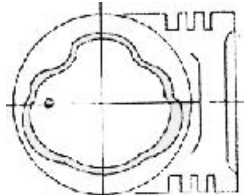

#97

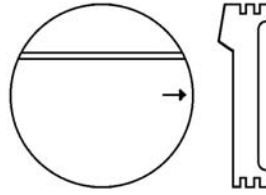

#98

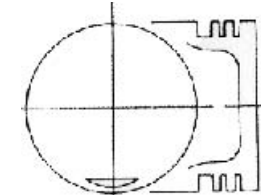

#99

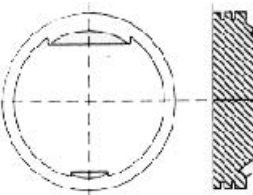

#100

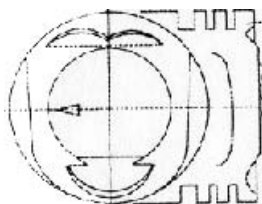

#101

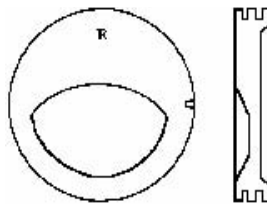

#102

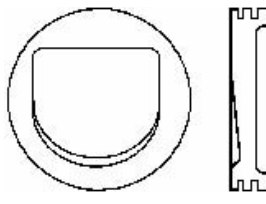

#103

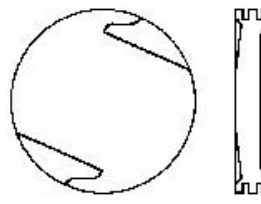

#104

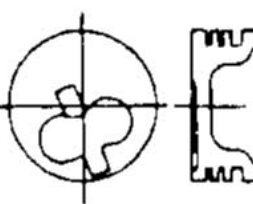

#105

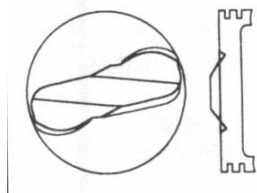

#106

| New CEP# | TC # | Set Qty | Bore (in.) | Bore (mm.) | Comp. Ratio | Comp. Height | Piston Length | Pin Diameter | Head Config. | *Mat'l. | Min. Skirt Clearance | Measure Skirt Clearance at: |
|----------|-----------|---------|------------|------------|--------------|--------------|---------------|--------------|--------------|---------|----------------------|-----------------------------|
| 224-1343 | - | - | 4.500 | 114.30 | 7.2:1 | 2.72 | 4.76 | 1.2199 | 20 | - | .0030 | Bottom of skirt |
| 224-1358 | - | - | 3.910 | 99.30 | 8.8:1 | 1.791 | 3.20 | 0.9842 | 2 | - | .0015 | .375" up from skirt bottom |
| 224-1397 | TC1397 | 6 | 3.400 | 86.40 | 8.7:1 | 1.740 | 3.49 | 0.9012 | 1 | - | .0015 | 1.00" up from skirt bottom |
| 224-1408 | TC1408 | 8 | 4.125 | 104.80 | 7.5:1 | 1.880 | 3.82 | 1.094 | 3 | - | .0020 | .910" up from skirt bottom |
| 224-1411 | - | - | 4.250 | 108.000 | 7.8:1 | 2.588 | 4.40 | 1.2399 | 5 | - | .0025 | top of Skirt Slipper |
| 224-1438 | - | - | 4.375 | 111.100 | 6.5:1 | 2.310 | 4.50 | 1.109 | 98 | - | .0030 | bottom of skirt |
| 224-1504 | TC1504 | 6 | 3.500 | 88.90 | 8.45:1 | 1.580 | 3.41 | 0.9122 | 1 | - | .0015 | 1.00" up from skirt bottom |
| - | TC1504A | 8 | 3.500 | 88.90 | 8.45:1 | 1.580 | 3.41 | 0.9122 | 1 | - | .0015 | 1.00" up from skirt bottom |
| 224-1526 | - | 6 | 3.563 | 90.50 | - | 1.784 | 3.703 | 0.927 | - | - | - | At top of skirt slipper |
| 224-1527 | TC1527 | 8 | 4.000 | 101.60 | 8.7:1 | 1.654 | 3.51 | 0.9273 | 6 | - | .0015 | 1.00" up from skirt bottom |
| 224-1529 | TC1529 | 8 | 3.800 | 78.00 | 8.4:1 | 1.580 | 3.41 | 0.9122 | 1 | - | .0015 | .844" up from skirt bottom |
| 224-1544 | TC1544 | 8 | 3.875 | 98.40 | varies | 1.779 | 3.78 | 0.9273 | 11 | - | .0015 | 1.00" up from skirt bottom |
| - | TC1544A | 6 | 3.875 | 98.40 | varies | 1.779 | 3.78 | 0.9273 | 11 | - | .0015 | 1.00" up from skirt bottom |
| - | TC1544B | 4 | 3.875 | 98.40 | varies | 1.779 | 3.78 | 0.9273 | 11 | - | .0015 | 1.00" up from skirt bottom |
| 224-1563 | TC1563 | 4 | 3 7/16 | 87.30 | varies | 1.998 | - | 0.8593 | 1 | - | .0020 | Bottom of skirt |
| - | TC1563A | 6 | 3 7/16 | 87.30 | varies | 1.998 | - | 0.8593 | 1 | - | .0020 | Bottom of skirt |
| 224-1568 | TC1568020 | 8 | 3.7500 | 95.25 | 8.3:1 | 1.835 | - | 0.9398 | 3 | - | .0015 | Bottom of skirt |
| 224-1595 | TC1595020 | 8 | 4.500 | 114.30 | 6.9:1 | 2.468 | 4.37 | 1.312 | 7 | - | .0030 | .437" up from skirt bottom |
| 224-1602 | - | - | 4.050 | 102.90 | 9.7:1 | 1.760 | 3.73 | 0.9752 | 91 | - | .0015 | 1.060" up from skirt bottom |
| 224-1650 | TC1650 | 6 | 3.680 | 93.50 | varies | 1.500 | 3.33 | 0.9122 | 25 | - | .0015 | 1.00" up from skirt bottom |
| 224-1658 | TC1658 | 6 | 3.875 | 98.40 | 8.4:1 | 1.640 | 3.50 | 0.9273 | 13 | - | .0015 | 1.00" up from skirt bottom |
| 224-1666 | TC1666 | 8 | 4.000 | 101.60 | 9.1:1 | 1.816 | 3.35 | 0.9752 | 6 | - | .0015 | .312" up from skirt bottom |
| 224-1670 | TC1670 | 8 | 4.120 | 104.60 | 8.2:1 | 1.700 | 3.28 | 0.9805 | 31 | - | .0015 | .250" up from skirt bottom |
| 224-1699 | TC1699 | 8 | 4.250 | 108.00 | varies | 1.848 | 3.78 | 1.094 | 1 | - | .0015 | 1.00" up from skirt bottom |
| 224-1701 | TC1701 | 6 | 4.000 | 101.60 | 8.0:1 | 1.747 | 3.39 | 0.9122 | 13 | - | .0025 | 1.125" up from skirt bottom |
| 224-1708 | TC1708 | 8 | 3.937 | 100.00 | 8.0:1 | 2.160 | 3.91 | 0.9898 | 74 | - | .0020 | 1.00" up from skirt bottom |
| 224-1712 | TC1712 | 8 | 4.050 | 102.90 | 9.4:1 | 1.760 | 3.73 | 0.9752 | 15 | - | .0015 | 1.00" up from skirt bottom |
| 224-1713 | TC1713 | 8 | 4.050 | 102.90 | 10.1 | 1.760 | 3.73 | 0.9752 | 6 | - | .0015 | 1.00" up from skirt bottom |
| 224-1715 | TC1715 | 6 | 3.750 | 95.25 | varies | 1.581 | 3.35 | 0.931 | 13 | - | .0015 | .750" up from skirt bottom |
| 224-1730 | TC1730 | 8 | 4.320 | 109.70 | 9.5:1, 8.8:1 | 1.970 | 3.59 | 1.094 | 17 | - | .0015 | .750" up from skirt bottom |
| 224-1735 | TC1735 | 8 | 4.1875 | 106.40 | 9.9:1 | 1.942 | 3.32 | 0.9997 | 6 | H | .0015 | Bottom of skirt |
| 224-1737 | TC1737 | 8 | 3.875 | 98.40 | 8.7:1 | 1.655 | 3.51 | 0.9273 | 3 | - | .0015 | .670" up from skirt bottom |
| 224-1740 | TC1740 | 8 | 4.057 | 103.00 | varies | 1.595 | 3.59 | 0.9805 | 25 | - | .0015 | 1.00" up from skirt bottom |
| 224-1746 | TC1746 | 8 | 4.125 | 104.80 | 8.4:1 | 1.720 | 3.47 | 0.9805 | 3 | - | .0015 | 1.00" up from skirt bottom |
| 224-1747 | TC1747 | 8 | 4.125 | 104.80 | 10.1:1 | 1.720 | 3.47 | 0.9805 | 11 | - | .0015 | 1.00" up from skirt bottom |
| 224-1749 | TC1749 | 8 | 3.875 | 98.40 | 7.8:1 | 1.700 | 3.28 | 0.9805 | - | - | .0015 | 1.00" up from skirt bottom |
| 224-1795 | TC1795 | 6 | 4.000 | 101.60 | varies | 1.577 | - | 0.9752 | 1 | - | .0015 | 1.00" up from skirt bottom |
| 224-1796 | TC1796 | 8 | 4.1875 | 106.40 | 7.5:1 | 2.019 | - | 1.094 | 19 | - | .0015 | 1.00" up from skirt bottom |
| 224-1810 | TC1810 | 8 | 4.000 | 101.60 | 7.65:1 | 1.739 | 3.50 | 0.9122 | 26 | - | .0015 | 1.00" up from skirt bottom |
| 224-1831 | TC1831 | 8 | 4.050 | 102.90 | 8.2:1 | 1.660 | 3.63 | 0.9752 | 15 | - | .0015 | 1.00" up from skirt bottom |
| 224-1832 | TC1832030 | - | 4.000 | 101.60 | varies | 1.719 | 3.47 | 0.9122 | 23 | - | .0015 | 1.125" up from skirt bottom |
| 224-1840 | TC1840 | 8 | 4.000 | 101.60 | 7.9:1 | 1.630 | 3.23 | 0.9752 | 29 | - | .0015 | 1.00" up from skirt bottom |
| - | TC1840A | 6 | 4.000 | 101.60 | 7.9:1 | 1.630 | 3.23 | 0.9752 | 29 | - | .0015 | 1.00" up from skirt bottom |
| 224-1842 | TC1842 | 6 | 4.000 | 101.60 | 8.0:1 | 1.740 | 3.67 | 0.9752 | 13 | - | .0015 | pin center line |
| 224-1843 | TC1843060 | 6 | 4.000 | 101.60 | 8.0:1 | 1.740 | 3.67 | 0.9752 | 13 | - | .0015 | 1.250" up from skirt bottom |
| 224-1845 | TC1845 | 8 | 4.000 | 101.60 | 8.0:1 | 1.540 | 3.19 | 0.9273 | 24 | - | .0015 | .750" up from skirt bottom |
| 224-1848 | TC1848 | 8 | 4.3125 | 109.50 | 8.4:1 | 1.955 | 3.33 | 0.9997 | 3 | - | .0020 | Bottom of skirt |
| 224-1849 | TC1849 | 8 | 4.150 | 105.40 | 8.0:1 | 3.070 | 3.07 | 0.9805 | 6 | - | .0015 | .900" up from skirt bottom |
| 224-1850 | TC1850 | 8 | 4.000 | 101.60 | varies | 1.576 | 3.16 | 0.9842 | 3 | - | .0015 | pin center line |
| 224-1852 | TC1852 | 8 | 4.125 | 104.80 | 8.5:1 | 1.540 | 3.18 | 0.9273 | 3 | - | .0015 | pin center line |
| 224-1856 | TC1856 | 8 | 4.360 | 110.70 | 8.0:1 | 1.760 | 3.73 | 1.04 | 35 | - | .0015 | 1.20" up from skirt bottom |
| 224-1860 | TC1860 | 8 | 4.250 | 108.00 | 8.0:1 | 2.160 | - | 0.9898 | 32 | - | .0025 | 1.06" from bottom of skirt |
| 224-1863 | TC1863 | 8 | 4.000 | 101.60 | 9.0:1 | 1.540 | 3.18 | 0.9273 | 33 | - | .0015 | 1.06" from bottom of skirt |
| 224-1866 | TC1866 | 8 | 4.342 | 110.30 | 8.0:1 | 1.812 | - | 1.094 | 1 | - | .0015 | .850" up from skirt bottom |
| 224-1868 | TC1868020 | 8 | 4.1650 | 105.90 | 8.5:1 | 1.488 | - | 1.0007 | 36 | - | .001 | .189" from top of Head |
| 224-1869 | TC1869 | 8 | 4.360 | 110.70 | varies | 1.882 | 3.85 | 1.04 | 35 | - | .0015 | 1.125" up from skirt bottom |
| 224-1870 | TC1870 | 8 | 4.250 | 108.00 | varies | 1.627 | 3.37 | 0.9898 | 81 | - | .0020 | 1.00" up from skirt bottom |
| 224-1882 | TC1882 | 8 | 3.875 | 98.40 | varies | 1.830 | 3.91 | 0.9752 | 13 | - | .0020 | .94" up from skirt bottom |
| 224-1884 | TC1884 | 8 | 4.125 | 104.80 | 8.0:1 | 1.907 | 303 | 1.062 | 54 | - | .0030 | Bottom of skirt |
| 224-1885 | TC1885 | 8 | 4.000 | 101.60 | 8.0:1 | 1.655 | 3.51 | 0.9273 | 84 | - | .0020 | 1.00" up from skirt bottom |
| 224-1889 | TC1889 | 6 | 3.875 | 98.40 | 8.0:1 | 2.009 | 3.70 | 0.9273 | 13 | - | .0025 | .500" up from skirt bottom |
| 224-1894 | TC1894 | 8 | 3.875 | 98.40 | 8.2:1 | 1.891 | 3.38 | 1.062 | 1 | - | .0030 | Bottom of pin boss |
| 224-1895 | TC1895 | 8 | 3.875 | 98.40 | 8.2:1 | 2.200 | 3.69 | 1.062 | 9 | - | .0030 | Bottom of pin boss |
| 224-1907 | - | - | 4.562 | 115.90 | 7.5:1 | 2.615 | - | 1.24 | 4 | - | .0030 | Bottom of pin boss |
| 224-1915 | - | - | 3.500 | 88.90 | 8.0:1 | 1.473 | 3.015 | 0.9272 | 1 | - | .002 | .750" up from skirt bottom |
| 224-1916 | TC1916 | 8 | 4.000 | 101.60 | varies | 1.585 | 3.34 | 0.9122 | 16 | - | .0015 | 1.00" up from skirt bottom |

*H = Hypereutectic

| <u>Rings</u> | <u>Notes</u> |
|------------------------|--|
| 3-3/32, 1-3/16 | .27" Dome head (not included in Comp. Dist.) Iron Top Groove. |
| 2-5/64, 1-3/16 | Flat head w/2 valve reliefs. |
| 2-5/64, 1-3/16 | Flat Head |
| 2-3/32, 1-3/16 | Recessed Head, Iron Top Groove |
| 3-3/32, 1-3/16 | Recessed Head, .12" Deep |
| 2-3/32, 1-3/16 | RD450 eng., .125" Step Head, not destroyed, Iron Top Groove |
| 2-5/64, 1-3/16 | Flat Head |
| 2-5/64, 1-3/16 | Flat Head |
| 2-5/64, 1-3/16 | Flat Head |
| 2-5/64, 1-3/16 | Flat Head with 4 Valve Reliefs |
| 1-5/64, 1-3/32, 1-3/16 | Flat Head |
| 2-5/64, 1-3/16 | Flat Head with 4 Valve Reliefs |
| 2-5/64, 1-3/16 | Flat Head with 4 Valve Reliefs |
| 2-5/64, 1-3/16 | Flat Head with 4 Valve Reliefs |
| 3-1/8, 1-1/4 | Flat Head. F162 and F4162 Engines. |
| 3-1/8, 1-1/4 | Flat Head. F162 and F4162 Engines. |
| 2-5/64, 1-3/16 | 3.06" dia. Head recess .23" deep. |
| 2-3/32, 1-3/16 | V549 engine. Contoured head, not destroyed. Iron Top Groove. |
| 1-5/64, 1-3/32, 1-3/16 | 2.687" dia. Head recess 5/64" deep w/ 4 valve reliefs. |
| 2-5/64, 1-3/16 | 2.25" dia. Head recess .093" deep. |
| 2-5/64, 1-3/16 | 3" head recess .060" deep. |
| 1-5/64, 1-3/32, 1-3/16 | Flat head w/Four valve reliefs |
| 2-5/64, 1-3/16 | Piston has 8 valve reliefs for use in either 1st or 2nd type engines. |
| 2-5/64, 1-3/16 | Flat head piston replacing both flat head and dished O.E. pistons. Not destroyed when used in 1971 engines. |
| 2-5/64, 1-3/16 | Recessed Head .28" deep (For 1965 Thru early 1969-before Chg.L16 |
| 1-3/32, 1-5/64, 1-3/16 | Trucks, not destroyed. Flat Head w/ one valve relief. Iron Top Groove. |
| 1-5/64, 1-3/32, 1-3/16 | 3" dia. Head recess 5/32" deep with four valve reliefs. |
| 1-5/64, 1-3/32, 1-3/16 | Four valve reliefs. Pin I.D. .700" |
| 2-5/64, 1-3/16 | "D" Shaped head recess. .120" deep. Replace in full sets only. |
| 2-5/64, 1-3/16 | Flat Head. Replaces both flat head and dished O.E. pistons. |
| 2-5/64, 1-3/16 | 3.48" dia. head recess .09" deep. |
| 2-5/64, 1-3/16 | Flat head w/4 valve reliefs. |
| 2-5/64, 1-3/16 | VIN R. 2.92" dia. Head recess .215" deep. |
| 2-5/64, 1-3/16 | 3.031" dia. head recess .324" deep. |
| 2-5/64, 1-3/16 | 2.94" dia. Head recess .120" deep. |
| 2-5/64, 1-3/16 | VIN P. Flat Head w/4 valve reliefs. |
| 2-5/64, 1-3/16 | Flat head. Replaces O.E. piston with recessed head. |
| 2-3/32, 1-3/16 | Truck engine. 3-1/4" dia. Head recess 7/32" deep. Iron Top Groove. |
| 2-5/64, 1-3/16 | Windsor Eng. Rectangular head recess .227" deep. |
| 1-5/64, 1-3/32, 1-3/16 | Car & Trk. Eng. 2-5/8" dia. Head recess 3/32" deep w/4 valve reliefs. |
| 2-5/64, 1-3/16 | Windsor eng. Flat Head with 4 valve reliefs. Cyl. Head 60cc=9.3:1 |
| 2-5/64, 1-3/16 | 2-5/16" dia. head recess 1/8" deep w/ 2 angled valve reliefs. |
| 2-5/64, 1-3/16 | 2-5/16" dia. head recess 1/8" deep w/ 2 angled valve reliefs. |
| 2-5/64, 1-3/16 | Trk. Eng. After L16, E or F150-350, P350-500. 3.25" dia. "D" shaped head recess 9/32" (.260") deep. |
| 2-5/64, 1-3/16 | Trk. Eng. After L16. 3.25" dia. "D" head recess .28" deep. Iron Top Groove. |
| 2-5/64, 1-3/16 | Trk. Eng., Series 40 & 50. 3.500" head recess .140" deep w/2 valve reliefs. |
| 2-5/64, 1-3/16 | 3.61" dia. Head recess .245" deep. |
| 1-5/64, 1-1/16, 1-3/16 | Flat Head w/4 valve reliefs. |
| 2-5/64, 1-3/16 | 3.13" dia. Head recess .05" deep. Thru 1992 Trks. |
| 2-5/64, 1-3/16 | Small Block. 3.46" dia. Head recess .145" deep. |
| 2-5/64, 1-3/16 | Car & Trk. non-EFI. .228" deep head recess w/2valve reliefs (20cc head) |
| 1-3/32, 2-5/64, 1-3/16 | Trk. Eng. Flat head w/one valve relief. Iron Top Groove. |
| 2-5/64, 1-3/16 | Trk. Eng. Series 10 though 30 exc. Light duty. Flat head w/2valve reliefs. |
| 2-5/64, 1-3/16 | Flat Head. |
| 2-5/64, 1-3/16 | 3.530" dia. Head recess .325" deep. V400 Eng. |
| 2-5/64, 1-3/16 | Oblong head recess .100" deep with 2 angled valve reliefs. |
| 2-5/64, 1-3/16 | Flat Head piston w/2valve reliefs. Used in either left or right bank cylinder banks. For 1970 replace in full sets only. |
| 1-5/64, 1-3/32, 1-3/16 | Trk. Eng., medium and heavy duty. 3.218" dia. "D" shaped head recess 5/64" deep. Pin I.D. .700" |
| 2-3/32, 1-3/16 | Exhaust Emission engine. Recessed head, not destroyed. Iron Top Groove. |
| 2-5/64, 1-3/16 | Trk. Eng. 3-1/4" dia. Head recess 5/64" deep w/2 valve reliefs. |
| 2-3/32, 1-3/16 | Trk. Eng. 3.187" dia. Head recess .328" deep. |
| 2-3/32, 1-3/16 | Exhaust emission engine. Recessed head, not destroyed. Iron Top Groove. |
| 2-3/32, 1-3/16 | Contoured Head, Not destroyed. V345 , V304 , Scout eng. Iron Top Groove. |
| 2-3/32, 1-3/16 | 3.16" dia. Head recess .375" deep. Hollow pin. Iron Top Groove. |
| 2-5/64, 1-3/16 | Flat head. Recommended for use w/sleeved engine only. Chevy Vega. |
| 2-5/64, 1-3/16 | 2.50" dia. Head recess .156" deep w/4 valve reliefs. |

| New CEP# | TC # | Set Qty | Bore (in.) | Bore (mm.) | Comp. Ratio | Comp. Height | Piston Length | Pin Diameter | Head Config. | *Mat'l. | Min. Skirt Clearance | Measure Skirt Clearance at: |
|----------|------------|---------|------------|------------|-------------|--------------|---------------|--------------|--------------|---------|----------------------|-----------------------------|
| - | TC1916A | 6 | 4.000 | 101.60 | varies | 1.585 | 3.34 | 0.9122 | 16 | - | .0015 | 1.00" up from skirt bottom |
| 224-1921 | TC1921 | 8 | 4.000 | 101.60 | 7.9:1 | 1.630 | 3.23 | 0.9122 | 29 | - | .0015 | pin center line |
| 224-1930 | TC1930 | 8 | 3.910 | 99.30 | varies | 1.658 | 3.36 | 0.9842 | 1 | - | .0015 | .812" up from skirt bottom |
| 224-1946 | TC1946 | 4 | 3.7795 | 96.00 | - | 1.578 | 2.98 | 0.9122 | 8 | - | .0015 | .65" up from skirt bottom |
| 224-1949 | TC1949 | 8 | 3.800 | 96.52 | varies | 1.805 | 2.98 | 0.9398 | 3 | - | .0015 | top of skirt |
| - | TC1949A | 6 | 3.800 | 96.52 | varies | 1.805 | - | 0.9398 | 3 | - | .0015 | top of skirt |
| 224-1953 | TC1953 | 4 | 2.9528 | 75.00 | 9.0:1 | 36mm | - | 18mm | 1 | - | 0.04mm | 2.48" down from top |
| 224-1973 | TC1973 | 6 | 3.2677 | 83.00 | varies | 1.515 | 3.06 | 0.8267 | 34 | - | .0015 | .500" up from skirt bottom |
| 224-1976 | - | - | 3.2677 | 83.00 | varies | 1.480 | 3.06 | 0.8267 | 37 | - | .0015 | pin center line |
| 224-1979 | TC1979 | 4 | 3.3464 | 85.00 | - | 37.740 | 3.065 | 21mm | 38 | - | .0014 | 3.25" below centerline |
| 224-1999 | TC1999 | 6 | 3.6614 | 93.00 | 8.0:1 | 1.511 | 2.87 | 0.945 | 1 | - | .0015 | .450" up from skirt bottom |
| 224-2001 | TC2001 | 8 | 4.000 | 101.6 | 7.9:1 | 1.921 | 3.53 | 0.9752 | 29 | - | .0015 | 1.00" up from skirt bottom |
| 224-2002 | TC2002 | - | 4.050 | 102.90 | 7.2:1 | 1.902 | 3.90 | 0.9752 | 39 | - | .0020 | .875" up from skirt bottom |
| 224-2004 | TC2004 | 8 | 4.050 | 102.90 | 7.2:1 | 1.760 | 3.656 | 0.9752 | 25 | - | .0020 | 1.100" up from skirt bottom |
| 224-2006 | TC2006 | 4 | 3.307 | 84.00 | 8.0:1 | 1.435 | 3.14 | 0.8665 | 1 | - | .0015 | .850" up from skirt bottom |
| 224-2007 | TC2007 | 8 | 3.910 | 99.30 | varies | 1.741 | 3.43 | 0.9842 | 11 | - | .0015 | pin center line |
| - | TC2007A | 6 | 3.910 | 99.30 | varies | 1.741 | 3.43 | 0.9842 | 11 | - | .0015 | pin center line |
| 224-2009 | TC2009 | 8 | 4.320 | 109.70 | 8.0:1 | 1.912 | 3.53 | 1.094 | 1 | - | .0015 | .600" up from skirt bottom |
| 224-2010 | TC2010 | 4 | 3.1300 | - | - | 1.642 | 2.856 | 0.866 | 4 | - | .0008 | .375" up from skirt bottom |
| 224-2012 | TC2012 | 8 | 3.736 | 94.90 | varies | 1.540 | 3.19 | 0.9273 | 3 | - | .0015 | .95" Up from bottom |
| - | TC2012A | 6 | 3.736 | 94.90 | 8.6:1 | 1.540 | 3.19 | 0.9273 | 3 | - | .0015 | .95" Up from bottom |
| 224-2015 | TC2015 | 4 | 3.0709 | 78.00 | 8.3:1 | 1.455 | 2.91 | 0.8665 | 14 | - | .0015 | .600" up from skirt bottom |
| 224-2016 | TC2016 | 6 | 3.3858 | 86.00 | 8.3:1 | 38.3mm | - | 21.00mm | 3 | - | 0.04mm | 3.25" below centerline |
| 224-2022 | TC2022030 | 8 | 4.125 | 104.80 | 8.0:1 | 2.200 | 3.33 | 1.062 | 9 | - | .0030 | pin center line |
| - | TC2022A030 | 4 | 4.125 | 104.80 | 8.0:1 | 2.200 | 3.33 | 1.062 | 9 | - | .0030 | pin center line |
| 224-2034 | TC2034 | 8 | 4.000 | 101.60 | 8.0:1 | 1.570 | 3.27 | 0.9273 | 1 | - | .0015 | .800" up from skirt bottom |
| - | TC2034B | 4 | 4.000 | 101.60 | varies | 1.570 | 3.27 | 0.9273 | 1 | - | .0015 | .800" up from skirt bottom |
| 224-2035 | - | - | 4.300 | 109.00 | 8.1:1 | 1.882 | 3.28 | 0.9997 | 1 | - | .0010 | pin center line |
| 224-2036 | TC2036 | 8 | 3.500 | 88.90 | varies | 1.575 | 3.60 | 0.9805 | 3 | - | .0015 | 1.125" up from skirt bottom |
| 224-2037 | TC2037 | 8 | 4.125 | 104.80 | 8.0:1 | 1.920 | 3.41 | 1.020 | 25 | - | .0020 | .700" up from skirt bottom |
| 224-2038 | TC2038 | 8 | 4.351 | 110.50 | 7.9:1 | 1.595 | 3.35 | 0.9805 | 3 | - | .0015 | 1.00" up from skirt bottom |
| 224-2039 | TC2039 | 6 | 4.000 | 101.60 | 8.8:1 | 1.763 | 3.37 | 0.9752 | 43 | - | .0015 | .900" up from skirt bottom |
| 224-2040 | TC2040 | 8 | 4.000 | 101.60 | 8.1:1 | 1.752 | 3.35 | 0.9122 | 27 | - | .0015 | 1.60" up from skirt bottom |
| 224-2042 | TC2042 | 8 | 3.500 | 88.90 | varies | 1.540 | 2.98 | 0.9273 | 3 | - | .0015 | .750" up from skirt bottom |
| - | TC2042A | 6 | 3.500 | 88.90 | varies | 1.540 | 2.98 | 0.9273 | 3 | - | .0015 | .750" up from skirt bottom |
| 224-2047 | - | - | 2.8740 | 73.00 | - | 38.5mm | - | 20mm | 40 | - | .04mm | .375" up from skirt bottom |
| 224-2050 | TC2050 | 4 | 2.9134 | 74.00 | 7.9:1 | 1.070 | 2.25 | 0.6692 | 3 | - | .0015 | .75" from bottom |
| 224-2052 | - | - | 2.9134 | 74.00 | 7.9:1 | 27.6mm | - | 17mm | 4 | - | .04mm | |
| 224-2053 | TC2053 | 4 | 3.031 | 77.00 | 8.8:1 | 1.063 | 2.44 | 0.7087 | 17 | - | .0012 | .470" up from skirt bottom |
| 224-2054 | - | - | 2.8346 | 72.00 | 8.1:1 | 30.0mm | - | 17mm | 14 | - | .01mm | .500" up from skirt bottom |
| 224-2055 | TC2055 | 4 | 3.307 | 84.00 | 8.4:1 | 1.435 | 3.13 | 0.8665 | 17 | - | .0015 | 1.00" up from skirt bottom |
| 224-2067 | TC2067 | 6 | 3.500 | 88.90 | - | 1.797 | 2.975 | 0.940 | 17 | - | .0024 | bottom of skirt |
| 224-2073 | TC2073 | 4 | 3.346 | 85.00 | 8.5:1 | 1.482 | 3.06 | 0.8267 | 4 | - | .0015 | .800" up from skirt bottom |
| 224-2079 | TC2079 | 4 | 3.3465 | 85.00 | 9.0:1 | 7.762 | 3.58 | 0.8664 | 100 | - | .002 | .945" up from skirt bottom |
| 224-2081 | - | - | 3.7008 | 94.00 | 8.3:1 | 47.6mm | - | 25.15mm | 14 | - | .02mm | .625" up from skirt bottom |
| 224-2088 | TC2088 | 4 | 3.2283 | 82.00 | 8.5:1 | 1.288 | 2.660 | 0.9055 | 3 | - | .0010 | .600" up from skirt bottom |
| 224-2093 | TC2093 | 4 | 3.307 | 84.00 | 8.5:1 | 39.6mm | 3.122 | 22mm | 99 | - | .0012 | 3.25" below centerline |
| 224-2099 | TC2099 | 4 | 2.9134 | 74.00 | 8.8:1 | 29mm | - | 18mm | 93 | - | .01mm | .433" up from skirt bottom |
| 224-2101 | TC2101 | 4 | 3.484 | 88.50 | 8.4:1 | 1.510 | 3.39 | 0.8665 | 37 | - | .0015 | 1" Up from bottom |
| 224-2108 | TC2108 | 8 | 4.000 | 101.60 | varies | 1.585 | 3.34 | 0.9122 | 42 | - | .0015 | pin center line |
| - | TC3055 | 8 | 4.057 | 103.00 | varies | 1.770 | 3.36 | 1.095 | 44 | - | .0035 | .700" up from skirt bottom |
| - | TC3055A | 6 | 4.057 | 103.00 | varies | 1.770 | 3.36 | 1.095 | 44 | - | .0035 | .700" up from skirt bottom |
| 224-2114 | - | - | 3.012 | 76.51 | 23.5:1 | 1.768 | 3.027 | 0.866 | 18 | - | | See O.E. repair manual |
| 224-2117 | - | - | 3.0709 | 78.00 | 8.3:1 | 1.555 | - | 0.8658 | 4 | - | .0015 | .600" up from skirt bottom |
| 224-2120 | TC2120 | 8 | 4.360 | 110.70 | 8.0:1 | 2.140 | 3.61 | 1.040 | 81 | - | .0025 | .75" Up from bottom |
| 224-2122 | TC2122 | 8 | 4.050 | 102.90 | 8.0:1 | 2.120 | 3.59 | 1.040 | 81 | - | .0020 | .80" up from bottom |
| 224-2123 | TC2123 | 6 | 3.965 | 100.70 | 8.0:1 | 1.808 | 2.99 | 0.9398 | 3 | - | .0015 | at bottom of skirt |
| 224-2125 | TC2125 | 4 | 3.228 | 82.00 | 8.6:1 | 1.474 | 2.970 | 0.9055 | 3 | - | .0010 | .700" up from skirt bottom |
| 224-2126 | - | - | 3.800 | 96.52 | 8.2:1 | 2.007 | - | 0.9996 | 1 | - | .0015 | .750" up from skirt bottom |
| 224-2127 | TC2127 | 8 | 3.680 | 93.50 | 8.8:1 | 1.585 | 3.12 | 0.9122 | 45 | - | .0015 | .800" up from skirt bottom |
| 224-2128 | TC2128 | 4 | 3.1875 | 81.00 | 8.6:1 | 1.633 | - | 0.812 | 17 | - | .001 | .700" up from skirt bottom |
| 224-2130 | TC2130 | 6 | 3.504 | 89.00 | 8.5:1 | 1.578 | 3.03 | 0.9055 | 1 | - | .0012 | .750" up from skirt bottom |
| - | TC2130B | 4 | 3.504 | 89.00 | 8.5:1 | 1.578 | - | 0.9055 | 1 | - | .0012 | .750" up from skirt bottom |
| 224-2132 | TC2132 | 8 | 3.800 | 96.50 | 7.9:1 | 1.595 | 3.60 | 0.9805 | 3 | - | .0015 | 1.00" up from skirt bottom |
| 224-2141 | TC2141 | 4 | 4.000 | 101.60 | 9.0:1 | 1.570 | 3.25 | 0.9273 | 3 | - | .0025 | .80" up from skirt bottom |

*H = Hypereutectic

| <u>Rings</u> | <u>Notes</u> |
|------------------------------|---|
| 2-5/64, 1-3/16 | 2.50" dia. Head recess .156" deep w/4 valve reliefs. |
| 2-5/64, 1-3/16 | Cleveland eng. 2.75" dia. Head recess 1/16" deep, 2 angled valve reliefs. |
| 2-5/64, 1-3/16 | Trk. Premium engine. Flat Head, replaces both cup and flat head O.E. pistons |
| 2-5/64, 1-3/16 | Flat Head w/2 Valve reliefs. Non-Turbo Courier. Pinto, Mustang II. |
| 2-5/64, 1-3/16 | 3.05" dia. Head recess .215" deep. Non-Turbo, VIN A. |
| 2-5/64, 1-3/16 | 3.05" dia. Head recess .215" deep. Non-Turbo, VIN A. |
| 2-2.0mm, 1-4.0mm | Flat Head. K, 3K, 4K engs. |
| 2-2.0mm, 1-4.0mm | Flat Head w/2 valve reliefs. 240Z with L24 eng. 260Z with L26 eng. |
| 2-2.0mm, 1-4.0mm | 2.75" dia. Head recess .055" deep. All with L16 eng. U20 eng. |
| 2-2.0mm, 1-4.0mm | Recessed head 3mm deep. L18 eng. 610, 620, 710 OHC |
| 1-2.0mm, 1-2.5mm, 1-4.0mm | Flat Head. Capri and Mustang II. |
| 2-5/64, 1-3/16 | 2.6" dia. Head recess 0.68" deep w/ 2 angled valve reliefs. |
| 1-3/32, 1-5/64, 1-3/16 | 2.6" head recess .19" deep. Iron Top Groove. 359/361 trk. Eng. After Engine U40000. 3 ring piston. |
| 1-3/32, 1-5/64, 1-3/16 | 3" dia. Head recess .31" deep. Trk. Eng. Iron Top Groove. |
| 2-2.0mm, 1-4.0mm | Flat Head. LUV Series 1, 2, 3 & 4. |
| 2-5/64, 1-3/16 | Flat top w/4 valve reliefs. 318 cid eng.1973 press fit, no lockrings. Use 1990 and earlier rings. 1991 and later use early style rings. |
| 2-5/64, 1-3/16 | Flat top w/4 valve reliefs. 239 cid eng. Grand Cherokee. Fl. Dakota. Availale in fuel injected mid-sized trucks and pickups.1973 press fit, no lockrings. |
| 2-5/64, 1-3/16 | Flat Head. |
| 1-1.75mm, 1-2.00mm, 1-4.00mm | Concave Head. |
| 2-5/64, 1-3/16 | 3.06" dia. Head recess .09" deep. |
| 2-5/64, 1-3/16 | 3.06" dia. Head recess .09" deep. |
| 2-1.5mm, 1-4.0mm | Dome head .310" high. May be used to replace piston with dished head. Courier 1800cc eng. |
| 2-2.00mm, 1-4.00mm | 74.00mm dia. Head recess 3.10mm deep. L28 eng. (To 7-79 on non-usa cars). Press Fit Pin. |
| 2-3/32, 1-3/16 | Without Exhaust Emission. Countoured Head. Not Destroked |
| 2-3/32, 1-3/16 | Without Exhaust Emission. Countoured Head. Not Destroked |
| 2-5/64, 1-3/16 | Flat Head. |
| 2-5/64, 1-3/16 | Flat Head. Chevy-Iron Duke. Olds-All 151 engs. in 1978. All VIN 1 w/Calif. in 1979. |
| 2-5/64, 1-3/16 | 2-1/2" dia. Head recess 1/8" deep. (7cc dish). |
| 2-5/64, 1-3/16 | 2.35" dia. Head recess .165" deep. |
| 2-3/32, 1-3/16 | 3.500" dia. Head recess .325" deep. Not destoked. MV404 & MV446 eng. |
| 2-5/64, 1-3/16 | 3.23" dia. Head recess .146" deep. |
| 2-5/64, 1-3/16 | 2.4" Dia. Off center circular head recess .30" deep. Trk Eng. |
| 2-5/64, 1-3/16 | rectangular head recess .105" deep w/2 valve reliefs, 11.5cc. Windsor Eng. |
| 2-5/64, 1-3/16 | 2.875" dia. Head recess .125" deep. |
| 2-5/64, 1-3/16 | 2.875" dia. Head recess .125" deep. |
| 2-2.00mm, 1-4.00mm | Domed head 60.50mm dia, 1.50mm high. TC Eng. SOHC. |
| 2-1.50mm, 1-4.00mm | Recessed head .085". ED1, ED2, ED3, ED4 engs. |
| 2-1.50mm, 1-4.00mm | 53mm dia. Recessed head 1.50mm deep. EC & ED eng. |
| 2-1.5mm, 1-4.0mm | 2.215" dia. Head recess .054" deep. Accord EK1 eng. |
| 2-1.50mm, 1-4.00mm | 65mm dia domed head 2.50mm high. EB2, EB3, EE engines. |
| 2-2.0mm, 1-4.0mm | 280" dia. head recess .068" deep. Isuzu-G180Z eng. Chevy-LUV series 5, 6, 8, 9, 10, 11 & 12. Buick-Used in Opel. |
| 2-5/64, 1-3/16 | - |
| 2-2.0mm, 1-4.0mm | 2.91" dia. Head recess .10" deep. All with L20 eng. |
| 2-2.0mm, 1-4.0mm | .23" Dome included in compresion distance w/2 valve reliefs. For all except engs. Built from 8-74 to 8-76. Use in sets only after 8-77 |
| 1-2.00mm, 1-2.50mm, 1-4.00mm | 75mm dia.Domed head 6.50mm high. 2F eng. |
| 2-1.5mm, 1-4.0mm | 2-3/8" dia. head recess, 3/32" deep. For 1976 replace in full sets only. |
| 2-2.00mm, 1-4.00mm | U, 4G52 eng.Flat head w/1 valve relief. |
| 2-1.50mm, 1-4.00mm | 66mm dia. Recessed head 1.50mm deep. SOHC Mitsubishi "J" eng. (1979-84), "Q" eng. (1980-84) |
| 1-2.0mm, 1-2.5mm, 1-4.0mm | .110" Crown head. 20R eng. |
| 2-5/64, 1-3/16 | Flat top with 4 valve reliefs. |
| 2-5/64, 1-3/16 | 2 Large Valve Reliefs with Fire Slot. For use on either Right or Left cyl. Bank. Iron Top Groove. LF9 Diesel. |
| 2-5/64, 1-3/16 | 2 Large Valve Reliefs with Fire Slot. For use on either Right or Left cyl. Bank. Iron Top Groove. LT6 Diesel. LT7 with Fire Slot. |
| 1-1.75mm, 1-2.00mm, 1-3.00mm | Swirl Chamber Recess 1.8mm deep. Volkswagon Golf, Passat Diesel. (8/76-7/80) |
| 2-1.50mm, 1-4.00mm | 2.181 dia. Recessed head, .100" deep. Courier VB eng. |
| 1-3/32, 1-5/64, 1-3/16 | Flat Head w/2 valve reliefs. Trk. Eng. Iron Groove. |
| 1-3/32, 1-5/64, 1-3/16 | Flat Head w/2 valve reliefs. Trk. Eng. Iron Groove. |
| 2-5/64, 1-3/16 | 3.913" dia. Head recess .256" deep. |
| 2-1.5mm, 1-4.0mm | 2.46" dia. Head recess .020" deep. |
| 2-5/64, 1-3/16 | Flat Head. Shallow Oil Groove. |
| 2-5/64, 1-3/16 | Flat Head w/4 valve reliefs. |
| 1-1/16, 1-5/64, 1-5/32 | 2.290" dia. Recessed head .500" deep. 1978-80 car. |
| 1-1.5mm, 1-2.0mm, 1-4.75mm | Flat Head. VIN W. 2nd design with 1.5mm top ring. |
| 1-1.5mm, 1-2.0mm, 1-4.75mm | Flat Head. VIN W. 2nd design with 1.5mm top ring. |
| 2-5/64, 1-3/16 | 2.70" dia head recess .107" deep. |
| 1-1/16, 1-5/64, 1-3/16 | 3.07" dia. Head recess .226" deep. Shallow groove. Low Tension rings. |

| New CEP# | TC # | Set Qty | Bore (in.) | Bore (mm.) | Comp. Ratio | Comp. Height | Piston Length | Pin Diameter | Head Config. | *Mat'l. | Min. Skirt Clearance | Measure Skirt Clearance at: |
|----------|---------|---------|------------|------------|-------------|--------------|---------------|--------------|--------------|---------|----------------------|------------------------------|
| 224-2151 | TC2151 | 4 | 3.1496 | 80.00 | 8.0:1 | 1.406 | 2.86 | 0.7868 | 1 | - | .0013 | .700" up from skirt bottom |
| 224-2154 | TC2154 | 4 | 2.992 | 76.00 | 8.5:1 | 30mm | 2.559 | 19mm | 43 | - | .0012 | |
| 224-2158 | TC2158 | 6 | 3.750 | 95.25 | 8.2:1 | 1.632 | 3.40 | 0.931 | 46 | - | .0015 | .310" up from skirt bottom |
| 224-2159 | TC2159 | 4 | 3.5866 | 91.10 | 8.2:1 | 1.385 | 3.06 | 0.8662 | 1 | - | .0015 | .750" up from skirt bottom |
| 224-2178 | - | - | 3.4250 | 87.00 | 8.5:1 | 1.398 | 2.835 | 0.827 | 47 | - | .0008 | .700" up from skirt bottom |
| 224-2179 | TC2179 | 6 | 3.8000 | 96.50 | 8.0:1 | 1.805 | 2.99 | 0.9398 | 3 | - | .0015 | bottom of skirt |
| 224-2182 | - | 4 | 3.3465 | 85.00 | 8.5:1 | 1.260 | 2.637 | 21.0mm | - | - | .0004 | 1.260" Down from top of head |
| 224-2185 | TC2185 | 8 | 3.9764 | 101.00 | 20.1:1 | 2.119 | 3.3 | 1.22 | 18 | - | .0025" | .375" Up from bottom. |
| 224-2187 | TC2187 | 6 | 3.811 | 96.80 | 8.65:1 | 1.584 | 3.031 | 0.9122 | 48 | - | .0015 | .750" up from skirt bottom |
| 224-2190 | TC2190 | 8 | 4.000 | 101.60 | 19.7:1 | 1.945 | 3.45 | 1.11 | 18 | - | .0050 | 1.500" up from skirt bottom |
| 224-2192 | TC2192 | 4 | 3.4449 | 87.50 | 8.5:1 | 1.570 | 3.02 | 0.9009 | 1 | - | .0014 | .650" up from skirt bottom |
| 224-2222 | TC2222 | 8 | 3.736 | 94.90 | 9.5:1 | 1.540 | 3.19 | 0.9273 | 6 | - | .0015 | pin center line |
| 224-2225 | TC2225 | 6 | 3.800 | 96.50 | 8.5:1 | 1.808 | 3.00 | 0.9398 | 1 | - | .0015 | bottom of skirt |
| 224-2226 | TC2226 | 4 | 3.1496 | 80.00 | 8.8:1 | 1.560 | 2.75 | 0.812 | 49 | - | .0026 | .250" up from skirt bottom |
| 224-2230 | TC2230 | 4 | 3.4449 | 87.50 | 8.5:1 | 1.593 | 3.00 | 0.9012 | 50 | H | .0023 | pin center line |
| 224-2231 | TC2231 | 8 | 3.7500 | 95.25 | 8.5:1 | 1.638 | - | 0.9309 | - | - | .0010 | 1.00" up from skirt bottom |
| 224-2234 | TC2234 | 8 | 4.08 | 103.63 | 9.0:1 | 1.580 | 3.54 | 0.931 | 51 | - | - | .750" up from skirt bottom |
| 224-2274 | TC2274 | 4 | 3.5180 | 89.40 | 8.0:1 | 1.578 | 2.98 | 0.9122 | 52 | - | .0015 | .580" up from skirt bottom |
| 224-2275 | TC2275 | 4 | 2.9134 | 74.00 | 8.9:1 | 27.7mm | 2.48 | 17mm | 100 | - | .0012 | 1.68" down from top |
| 224-2276 | - | - | 2.8346 | 72.00 | 7.9:1 | 27.5mm | - | 17mm | 17 | - | 0.01mm | bottom of skirt |
| 224-2281 | TC2281 | 4 | 3.3369 | 84.78 | 8.8:1 | 1.555 | - | 0.9055 | - | - | 0.001 | 2.43" down from top |
| 224-2283 | TC2283 | 4 | 3.680 | 93.50 | 9.0:1 | 1.500 | 3.03 | 0.9122 | 1 | - | .0015 | 1.126" up from skirt bottom |
| 224-2284 | - | - | 2.8346 | 72.00 | 8.0:1 | 27.5mm | 2.461 | 17mm | 4 | - | .0012 | bottom of skirt |
| 224-2289 | TC2289 | 4 | 3.3858 | 86.00 | 8.8:1 | 35mm | 2.756 | 22mm | 53 | - | .0012 | .71" up from skirt bottom |
| 224-2290 | - | - | 3.7008 | 94.00 | - | 47.9mm | - | 25.15mm | 1 | - | 0.02mm | 80.8mm from top of head |
| 224-2291 | TC2291 | 4 | 3.622 | 92.00 | 9.0:1 | 1.526 | 3.63 | 0.8665 | - | - | .0015 | 1.259" up from skirt bottom |
| 224-2297 | - | - | 3.031 | 77.00 | - | 1.220 | 2.48 | 0.787 | - | - | - | |
| 224-2300 | - | - | 3.3465 | 85.00 | - | 40.5mm | - | 22.0mm | 55 | - | 0.01mm | 52.5mm from top of dome |
| 224-2302 | - | - | 3.3268 | 84.50 | 8.5:1 | 1.165 | 2.26 | 0.7874 | 94 | - | .0015 | |
| 224-2303 | - | - | 2.9921 | 76.00 | - | 33.50mm | - | 19.0mm | 4 | - | 0.02mm | 36mm from top of head |
| 224-2304 | TC2304 | 4 | 2.9921 | 76.00 | 8.5:1 | 1.2795 | 2.46 | 0.748 | 56 | - | .0015 | |
| 224-2305 | TC2305 | 4 | 2.9921 | 76.00 | 9.4:1 | 1.262 | 2.44 | 0.7485 | 25 | - | - | .500" up from skirt bottom |
| 224-2308 | - | - | - | 80.00 | - | 1.425 | 2.882 | 0.787 | 1 | - | - | .687" up from skirt bottom |
| 224-2309 | - | - | - | 77.00 | - | 1.142 | 2.402 | 0.787 | - | - | - | .625" up from skirt bottom |
| 224-2310 | TC2310 | 4 | 3.307 | 84.00 | 8.7:1 | 33.4mm | 2.771 | 20mm | 53 | - | .0008 | .787" up from skirt bottom |
| 224-2311 | TC2311 | 4 | 3.189 | 81.00 | 9.0:1 | 1.193 | 2.37 | 0.709 | 107 | - | .0017 | .500" up from skirt bottom |
| 224-2312 | TC2312 | 6 | 3.2677 | 83.00 | 8.8:1 | 1.280 | 2.77 | 0.8665 | 57 | - | .0015 | bottom of pin boss |
| 224-2313 | - | - | 3.0512 | 77.50 | - | 31.0mm | - | 18.0mm | 33 | - | 0.01mm | 51mm from top of head |
| 224-2314 | - | - | 3.0512 | 77.50 | 9.1:1 | 1.201 | 2.39 | 0.7088 | 58 | - | .004 | bottom of skirt |
| 224-2315 | TC2315 | 4 | 3.622 | 92.00 | 9.3:1 | 1.355 | 2.49 | 0.8665 | 60 | - | .0015 | .500" up from skirt bottom |
| 224-2321 | TC2321 | 4 | 4.000 | 101.60 | - | 1.625 | 3.27 | 0.9273 | 13 | H | .0020 | 1.00" up from skirt bottom |
| 224-2322 | TC2322 | 6 | 4.000 | 101.60 | 9.2:1 | 1.581 | 3.29 | 0.931 | - | - | .0015 | pin center line |
| - | TC2322B | 4 | 4.000 | 101.60 | 9.2:1 | 1.581 | 3.29 | 0.931 | 46 | - | .0015 | pin center line |
| 224-2330 | TC2330 | 4 | 3.327 | 84.50 | 8.5:1 | 29.5mm | 2.559 | 20mm | 47 | - | .0015 | .600" up from skirt bottom |
| 224-2331 | TC2331 | 6 | 3.425 | 87.00 | varies | 1.250 | 2.62 | 0.8259 | 81 | - | .0015 | .562" up from skirt bottom |
| 224-2332 | TC2332 | 4 | - | 96.00 | - | - | - | - | - | - | - | .750" up from skirt bottom |
| 224-2334 | TC2334 | 4 | 2.972 | 75.50 | 9.4:1 | 29mm | 2.283 | 18mm | 93 | - | .0008 | .500" up from skirt bottom |
| 224-2335 | TC2335 | 4 | 3.425 | 87.00 | 8.4:1 | 1.455 | 3.15 | 0.8662 | - | - | .001 | 2.35" from top of head |
| 224-2336 | - | - | - | 76.50 | - | 1.643 | 2.822 | 24mm | - | - | - | See O.E. repair manual |
| 224-2338 | - | - | 3.310 | - | - | 1.752 | 2.937 | 0.984 | 18 | - | .0010 | .312" up from skirt bottom |
| 224-2347 | TC2347 | 4 | 3.4449 | 87.50 | 9.0:1 | 1.573 | 2.78 | 0.9009 | 61 | - | .0013 | .400" up from skirt bottom |
| 224-2348 | TC2348 | 4 | 3.4449 | 87.50 | varies | 1.573 | 2.78 | 0.9009 | - | - | .0013 | .400" up from skirt bottom |
| 224-2349 | TC2349 | 4 | 3.4449 | 87.50 | 8.0:1 | 1.591 | 2.76 | 0.9009 | 61 | H | .0023 | .720" Up from bottom |
| 224-2350 | TC2350 | 4 | 3.2260 | 81.94 | 9.0:1 | 1.470 | 2.65 | 0.8121 | 62 | - | .0020 | .475" Up from bottom |
| 224-2351 | TC2351 | 4 | 3.2260 | 81.94 | 9.0:1 | 1.540 | 2.92 | 0.8121 | 1 | - | .0020 | .60" Up from bottom |
| 224-2353 | TC2353 | 6 | 3.504 | 89.00 | 9.3:1 | 1.535 | 2.64 | 0.9122 | 1 | H | .0015 | .38" Up from bottom |
| 224-2357 | TC2357 | 6 | 3.504 | 89.00 | 8.5:1 | 1.599 | 3.05 | 0.9055 | 1 | - | .0012 | .700" Up from bottom |
| 224-2358 | TC2358 | 4 | 3.504 | 89.00 | 9.0:1 | 1.578 | 2.76 | 0.8002 | 16 | - | .0012 | top of skirt slipper |
| 224-2359 | TC2359 | 8 | 3.464 | 88.00 | 8.5:1 | 1.630 | 3.33 | 0.8657 | 3 | - | .0015 | top of skirt slipper |
| 224-2364 | - | - | 3.012 | 76.50 | 23.5:1 | 1.642 | 2.822 | 0.945 | 18 | - | 0.0012 | 1.00" up from skirt bottom |
| 224-2366 | - | - | 3.622 | 92.00 | 8.5:1 | 1.815 | 2.975 | 0.945 | 25 | - | 0.0012 | 1.00" up from skirt bottom |
| 224-2367 | - | - | 3.622 | 92.00 | 7.5:1 | 1.835 | 2.815 | 0.945 | 25 | - | 0.0012 | 1.00" up from skirt bottom |

*H = Hypereutectic

| <u>Rings</u> | <u>Notes</u> |
|------------------------------|--|
| 1-1.2mm, 1-1.5mm, 1-4.0mm | Flat Head. Use early design ring pack. Ford-Courier. |
| 1-1.2mm, 1-2.00mm, 1-4.00mm | Small round Recess in head . A15 eng. |
| 2-5/64, 1-3/16 | Recessed head .185" deep. |
| 2-2.00mm, 1-4.00mm | .200" recessed head. Shallow Oil Groove Mitsu.-F & W to 4/83. G54B eng. |
| 2-1.50mm, 1-4.00mm | Recessed head w/4 valve reliefs. |
| 2-5/64, 1-3/16 | 3.05" dia. Head recess .245" deep. Turbo. |
| 2-1.50mm, 1-4.00mm | Flat Head w/4 small recesses. (1980-81) Z20E, Z20S eng. From 1/80. (1980-89) Car & trk. (non-USA) Z20 eng., from 7/80. Use ring set# 41289. |
| 1-3.00mm, 1-2.00mm, 1-4.00mm | Ricardo recess .158 in. deep 6.2L GM Diesel. Ni-Resist Ring Carrier. |
| 2-2.00mm, 1-4.00mm | 2.170" dia head recess .071" deep w/2 valve reliefs. |
| 2-5/64, 1-7/64 | Diesel Trk. Swirl Chamber, (6.6cc cup). B Series. Not Destroyed. Iron Top Groove |
| 2-1.50mm, 1-4.0mm | Flat Top. Omni & Horizin with E62 Engine. 1983-86 C.R. = 9.0:1. Shallow Groove |
| 2-5/64, 1-3/16 | Flat head w/4 valve reliefs. H.O. engs. LU7 eng. TBI. |
| 2-5/64, 1-3/16 | Flat Top. Buick-LK9 eng. 1985 high deck engs, used in "C" cars only. |
| 2-1.50mm, 1-4.0mm | Dome head .310" high. May be used to replace dished head pistons. Courier 1800cc eng. |
| 2-1.50mm, 1-4.00mm | 2.20" dia. Head recess .190" deep. Turbo. Shallow Groove. Not Destroyed |
| 2-5/64, 1-3/16 | .170" Recessed head. Press Fit Pin. |
| 2-2.00mm, 1-5.00mm | 3.60" dia head recess .190" deep w/ 4 valve reliefs. |
| 2-2.00mm, 1-4.75mm | Flat head w/2 Valve reliefs Ranger. |
| 2-1.25mm, 1-2.80mm | Recessed Head w/2 valve reliefs. |
| 2-1.50mm, 1-4.00mm | 63.00mm dia head recess .50mm deep. EJ1 eng. |
| 1-1.50mm, 1-1.75mm, 1-4.00mm | 2.710" dia. Head recess .125" deep. Thin rings and shallow groove for low tension oil ring. Opel Brazilian eng. |
| 2-5/64, 1-3/16 | Flat Head. HSC Eng. |
| 2-1.50mm, 1-4.00mm | Recessed head .5mm deep. |
| 2-1.50mm, 1-4.00mm | Recessed head. |
| 1-2.00mm, 1-2.50mm, 1-4.00mm | Flat head w/0.3mm step rim. 2FE eng. |
| 1-2.00mm, 1-2.5mm, 1-4.0mm | Crown .25" high with 2.30" dia. Ead recess .20" deep. 22R eng. |
| 2-1.50mm, 1-4.00mm | Dish head, 1.2mm deep. Appl: 1979-80 1415cc 4 cyl. Mazda. |
| 2-1.50mm, 1-4.00mm | 70.00mm dia dome head 5.30mm high. Non-USA car: 3T eng. To 8/81. USA car-8/79 to 8/82 ETC eng. |
| 2-1.50mm, 1-4.00mm | Recessed head .06" deep w/4 valve reliefs. Use early style rings. CA20E, S only. |
| 2-1.50mm, 1-4.00mm | 70.00mm dia head recess, 10.00mm deep. Non usa car-E15 from 8/81-7/82. USA car-E15 eng.-310-Sentra from 8/81-7/82 |
| 2-1.50mm, 1-4.00mm | .420" recessed head; exc. Turbo. E15S, E15T. |
| 2-1.50mm, 1-4.00mm | 2.35" dia. Head recess .360" deep. E16, E16i & E16S engines. Sentra 82-88, Pulsar 84-88. 1987-88 EFI. |
| 1-1.50mm, 1-2.00mm, 1-4.00mm | Flat head. 1982-86 2000cc Mazda, B2000 & 626. |
| 1-1.50mm, 1-2.00mm, 1-4.00mm | Recessed head with 1 valve relief. 1983-85 Mazda 1500cc (GLC 1490). |
| 2-1.50mm, 1-4.00mm | Recessed head 4.2mm deep. 2SELG eng. |
| 2-1.50mm, 1-2.80mm | Heart Shaped recess .129" deep. 4ALC eng. Chevy-Nova. Toyota-OHC |
| 2-1.50mm, 1-4.00mm | Dome .143" high 2.37" dia. W/2 valve reliefs. Full Floating pin. 5MGE eng. |
| 2-1.50mm, 1-2.80mm | Flat head w/2 valve reliefs. 1AC eng. |
| 2-1.50mm, 1-2.80mm | Recessed head .11" deep w/2 valve reliefs. 3AC eng. |
| 2-1.50mm, 1-4.00mm | 2.50" dia. Head recess .070" deep w/ 2 valve reliefs. 22R eng. Replacement Style Piston |
| 2-5/64, 1-3/16 | 3.20" dia. Head recess .13" deep, (14cc cup). Mercruiser Marine reverse rotation engine. Not Destroyed. T6 Heat Treatment |
| 2-5/64, 1-3/16 | Rectangular head recess .096" deep. VIN U. |
| 2-5/64, 1-3/16 | Rectangular head recess .096" deep. VIN U. |
| 2-1.50mm, 1-4.00mm | Recessed head 1.7mm deep, w/4 valve reliefs. CA20E eng., CA20S eng. |
| 2-1.5mm, 1-2.8mm | Flat head w/2 valve reliefs. VG30E & VG30I eng. SOHC non-turbo. Late style rings. Use with part number 41578. 200SX, 300ZX, Maxima, Pathfinder, Pickup. Comes with lockrings. |
| | 11/82-5/85, 2389cc Datsun 720 Pickup (Z24) eng. |
| 2-1.50mm, 1-4.00mm | Recessed head .7mm deep w/4 valve reliefs. Mitsubishi& Chrysler-G15B, G4AJ eng., Chrysler-Q eng., Hyndai-G4AJ eng. |
| 2-1.50mm, 1-4.00mm | 1984-85 1949cc (G200Z eng.), Isuzu troper II. 1983-85 GMC "S" Series truck, (1.9L), 119 CID eng. SOHC. 1982 style ring pack (use w/ ring set# 41453) |
| 1-1.75mm, 1-2.00mm, 1-3.00mm | Ricardo Bowl head. |
| 1-2.50mm, 1-2.00mm, 1-4.50mm | - |
| 2-1.5mm, 1-4.0mm | 2.64" dia. Head recess .161" deep. Non-turbo, non-EFI. |
| 2-1.5mm, 1-4.0mm | Trench valve relief. Non-turbo. All Fuel Injected. Carb. Omni and Horizon. |
| 2-1.5mm, 1-4.0mm | 2.60" dia. Head recess .190" deep w/2 valve reliefs. Lock-rings included. Not destroyed. Shallow Groove. Turbo. |
| 2-1.5mm, 1-4.0mm | Flat head w/2 valve reliefs. Not EFI. Not Destroyed. Shallow Groove. |
| 2-1.5mm, 1-4.0mm | Contoured Head. EFI. Not Destroyed. Shallow Groove. |
| 2-1.5mm, 1-4.0mm | Flat head. Not destroyed after Jan. 1990. Pass. Car & trks. Not special HO models. Shallow Groove. |
| 1-1.5mm, 1-2.0mm, 1-4.75mm | Flat head. May replace 224--2130 but will not be Destroyed. Isuzu-Trooper & pickup. VIN R. Shallow Groove. |
| 2-1.5mm, 1-4.75mm | 2.37" dia. Head recess .155" deep. Small pin. Shallow Groove. |
| 2-2.0mm, 1-4.00mm | 2.10" dia. Head recess .142" deep. Available in .003" & .005" oversizes. VIN 8. Shallow Groove. |
| 1-1.75mm, 1-2.00mm, 1-3.00mm | Ricardo Bowl Head. Volkswagon Golf, akt., Aufladung, Fahrzeug (8/89-7/92); Jetta (8/89-9/91); USA Rabbit, Golf, Jetta, Passat, Santana, 245/247/251/253/255 (8/81-10/91); Passat (8/88-7/93); Aufladung, Fahrzeug: LT 28/31/35/40/45/50/55 (12/82-8/92). |
| 1-1.75mm, 1-2.00mm, 1-4.00mm | Recessed Head 2.1mm deep. Vergaser, Fahzeug: 242, 244, 245 (1974-1978); Einspritzung, Fahzeug: 242, 244, 245 (USA) (1979-80.) |
| 1-1.75mm, 1-2.00mm, 1-4.00mm | Recessed Head 2.3mm deep. Einspritzung, Aufladung; Fahrzeug: 240, 244, 245; Einspritzung Aufladung, Fahrzeug: 244 (USA) |

| New CEP# | TC # | Set Qty | Bore (in.) | Bore (mm.) | Comp. Ratio | Comp. Height | Piston Length | Pin Diameter | Head Config. | *Mat'l. | Min. Skirt Clearance | Measure Skirt Clearance at: |
|----------|-----------|---------|------------|------------|-------------|--------------|---------------|--------------|--------------|---------|----------------------|-------------------------------|
| 224-2368 | - | - | 3.012 | 76.50 | - | 1.647 | 2.824 | 0.945 | 18 | - | 0.0012 | 1.00" up from skirt bottom |
| 224-2374 | TC2374 | 4 | 2.9724 | 75.50 | 9.4:1 | 1.146 | 2.31 | 0.7088 | 13 | - | .0012 | 3.25" below pin centerline |
| 224-2375 | TC2375 | 4 | 3.5866 | 91.10 | - | 35.20mm | - | 22mm | 3 | - | 0.02mm | 67.2mm from top of head |
| 224-2377 | - | - | 3.268 | 83.00 | - | 30mm | 2.559 | 19.99mm | - | - | .0008 | .600" up from skirt bottom |
| 224-2378 | - | - | 3.346 | 85.00 | - | 32mm | 2.638 | 21.01mm | - | - | .0005 | .500" up from skirt bottom |
| 224-2379 | - | - | 3.3858 | 86.00 | - | 38mm | 3.079 | 21.01mm | - | - | .0008 | .625" up from skirt bottom |
| 224-2380 | - | - | 3.268 | 83.00 | - | 48.01mm | 3.543 | 26.01mm | - | - | .0030 | .562" up from skirt bottom |
| 224-2382 | - | - | 3.4645 | 88.00 | - | 47.50mm | 3.543 | 27mm | - | - | 0.0062 | .600" up from skirt bottom |
| 224-2384 | - | - | 3.14956 | 80.00 | varies | 30mm | 2.618 | 20mm | 47 | - | .0015 | top of skirt slipper |
| 224-2387 | - | - | 3.6220 | 92.00 | - | 1.937 | - | 27mm | 105 | - | 0.05mm | pin center line |
| 224-2500 | - | - | 3.3858 | 86.00 | varies | 35mm | 2.637 | 22mm | 63 | - | .0008 | .500" up from skirt bottom |
| 224-2511 | TC2511 | 8 | 4.000 | 101.60 | varies | 1.540 | 3.2 | 0.9273 | 6 | H | .0015 | top of skirt slipper |
| 224-2517 | TC2517 | 8 | 4.000 | 101.60 | 8.4:1 | 1.540 | 3.19 | 0.9273 | 25 | - | .0015 | pin center line |
| 224-2552 | TC2552 | 6 | 3.800 | 96.50 | 9.0:1 | 1.805 | 2.91 | 0.9398 | 3 | - | .0015 | bottom of skirt |
| 224-2553 | TC2553 | 8 | 4.082 | 103.70 | 8.2:1 | 2.003 | 3.72 | 0.9997 | 1 | - | .0015 | .880" up from skirt bottom |
| 224-2554 | TC2554 | 4 | 3.226 | 81.94 | 9.0:1 | 1.286 | 2.48 | 0.8121 | 65 | - | .0020 | Down 2.03" from top of head |
| 224-2555 | TC2555 | 6 | 3.811 | 96.80 | 9.0:1 | 1.614 | 2.71 | 0.9122 | 48 | - | .0015 | .450" up from skirt bottom |
| 224-2556 | TC2556 | 4 | 3.226 | 81.94 | 9.0:1 | 1.367 | 2.55 | 0.8121 | 49 | H | .0015 | .400" up from skirt bottom |
| 224-2557 | TC2557 | 4 | 2.7953 | 71.00 | 9.0:1 | 1.120 | 2.35 | 0.787 | 66 | - | .0013 | .500" up from skirt bottom |
| 224-2558 | TC2558 | 8 | 3.7360 | 94.90 | varies | 1.540 | 3.19 | 0.9275 | 91 | - | 0.001 | 1.80" from top of head |
| 224-2559 | TC2559 | 4 | 3.054 | 89.00 | 9.0:1 | 1.330 | 2.15 | 0.8002 | 3 | - | .0015 | .200" Up from bottom of head |
| 224-2561 | TC2561 | 4 | 3.3858 | 86.00 | 7.8:1 | 1.420 | 2.79 | 0.8657 | 67 | H | .0020 | .700" Up from bottom |
| 224-2563 | TC2563 | 4 | 3.3862 | 86.00 | 8.6:1 | 1.417 | 2.795 | 0.8653 | 67 | - | .0014 | 2.08" from top of head |
| 224-2565 | TC2565 | 8 | 4.040 | 102.60 | 10.2:1 | 1.824 | 3.51 | 0.9842 | 68 | - | .0015 | .875" up from skirt bottom |
| 224-2566 | TC2566 | 4 | 3.0709 | 78.00 | - | 1.230 | 2.46 | 0.7865 | 66 | - | .0021 | 1.98" from top of head |
| 224-2567 | TC2567 | 4 | 4.000 | 101.60 | varies | 1.566 | 2.85 | 0.9273 | 3 | H | .0015 | .500" up from skirt bottom |
| 224-2581 | TC2581 | 6 | 4.000 | 102.00 | 8.5:1 | 1.767 | 3.367 | 0.9751 | 13 | H | 0.001 | 2.47" from top of head |
| 224-2587 | TC2587 | 8 | 4.000 | 101.60 | 8.2:1 | 1.608 | 3.35 | 0.9122 | 69 | - | .0015 | 1.10" Up from bottom |
| 224-2625 | TC2625020 | 4 | 3.875 | 98.40 | 4.2:1 | 1.906 | - | 0.9997 | 1 | - | .0020 | bottom of skirt |
| 224-2692 | - | - | 3.0118 | 76.50 | - | 1.647 | 2.825 | 0.945 | - | - | .0012 | above skirt slipper |
| 224-2694 | TC2694 | 8 | 4.000 | 101.60 | 7.9:1 | 1.540 | 3.19 | 0.9273 | 91 | - | .0015 | .900" up from skirt bottom |
| - | TC2694A | 6 | 4.000 | 101.60 | 7.9:1 | 1.540 | 3.19 | 0.9273 | 91 | - | .0015 | .900" up from skirt bottom |
| 224-2695 | - | - | 3.3369 | 84.78 | 8.0:1 | 1.555 | 2.82 | 0.9055 | 56 | - | 0.001 | 2.43" from top of head |
| 224-2696 | - | - | 4.000 | 101.60 | - | 1.540 | 3.07 | 0.9275 | 15 | - | 0.001 | 2.23" from top of head |
| 224-2699 | TC2699 | 6 | 3.661 | 93.00 | 9.0:1 | 1.527 | 2.87 | 0.9450 | 61 | - | .0011 | .70" Up from bottom |
| 224-2701 | - | - | 3.5866 | 91.10 | - | - | - | - | - | - | .0010 | .550" up from skirt bottom |
| 224-2704 | - | - | 4.000 | 101.60 | 7.8:1 | 1.767 | 3.37 | 0.9751 | - | H | .0012 | 2.47" from top of head |
| 224-2705 | - | - | 3.7795 | 96.00 | - | 1.575 | 2.85 | 0.9122 | 8 | H | .0014 | 2.38" from top of head |
| 224-2707 | TC2707 | 8 | 4.250 | 108.00 | varies | 1.627 | 3.375 | 0.9898 | 71 | H | .0020 | 1.00" up from skirt bottom |
| 224-2712 | TC2712 | 4 | 3.3465 | 85.00 | 8.5:1 | 1.360 | 2.83 | 0.8267 | 72 | - | - | .688" Up from bottom |
| 224-2714 | - | - | 3.030 | 77.00 | - | 1.126 | 2.323 | 0.708 | - | - | .0015 | top of skirt slipper |
| 224-2715 | - | - | 3.030 | 77.00 | - | 1.126 | 2.323 | 0.708 | - | - | .0015 | top of skirt slipper |
| 224-2716 | - | - | 3.190 | 81.00 | - | 1.307 | 2.46 | 20mm | - | - | .0013 | .500" up from skirt bottom |
| 224-2719 | TC2719 | 3 | 2.913 | 74.00 | varies | 1.114 | 2.177 | 17mm | 73 | - | .0012 | 3.25" below centerline |
| 224-2735 | - | - | 4.000 | 101.60 | 7.6:1 | 1.640 | 3.28 | 0.9751 | 13 | - | .0025 | pin center line |
| 224-2736 | - | - | 3.386 | 86.00 | 8.6:1 | 36mm | 2.795 | 22mm | - | - | .0015 | top of skirt slipper |
| 224-2740 | TC2740 | 8 | 3.9375 | 100.00 | varies | 2.160 | 4.00 | 0.9898 | - | - | .0020 | 1.00" up from skirt bottom |
| 224-2741 | TC2741 | 8 | 4.250 | 108.00 | varies | 2.160 | 3.91 | 0.9898 | 75 | - | .0025 | 1.06" Up from bottom |
| 224-2742 | TC2742 | 8 | 3.1875 | 81.00 | 7.0:1 | 1.763 | 3.17 | 0.7503 | 22 | - | .0015 | bottom of skirt |
| 224-2744 | - | - | 4.250 | 108.00 | 8.2:1 | 1.634 | 3.38 | 0.9897 | 59 | - | .0015 | pin center line |
| 224-2745 | TC2745 | 8 | 4.000 | 101.60 | 8.5:1 | 1.540 | 3.19 | 0.9273 | 76 | - | .0015 | .90" Up from bottom |
| - | TC2745A | 6 | 4.000 | 101.60 | 8.5:1 | 1.540 | 3.19 | 0.9273 | 76 | - | .0015 | .90" Up from bottom |
| 224-2746 | TC2746 | 4 | 3.2260 | 81.94 | 9.0:1 | 1.540 | 2.72 | 0.8121 | 49 | - | .0020 | pin center line |
| 224-2747 | TC2747 | 8 | 3.1875 | 81.00 | 7.0:1 | 1.763 | - | 0.7503 | 22 | - | .0015 | .250" up from skirt bottom |
| 224-2751 | TC2751 | 6 | 3.250 | 82.60 | 6.9:1 | 1.978 | 3.66 | 0.8593 | 1 | - | .0015 | bottom of skirt |
| 224-2753 | - | - | 3.1875 | 81.00 | varies | 30.5mm | 2.539 | 20mm | 78 | - | .0008 | top of skirt slipper |
| 224-2754 | TC2754 | 4 | 3.385 | 86.00 | 8.8:1 | 1.171 | 2.12 | 0.8271 | 3 | - | .0015 | pin center line |
| 224-2755 | TC2755 | 6 | 3.700 | 94.00 | 9.0:1 | 1.310 | 2.43 | 0.9054 | 3 | - | .0015 | .750" up from skirt bottom |
| 224-2756 | TC2756 | 4 | 3.125 | 79.40 | varies | 2.167 | 3.73 | 0.8120 | 1 | - | .0020 | .375" Up from bottom of skirt |
| 224-2757 | TC2757 | 6 | 3.504 | 89.00 | 8.8:1 | 1.450 | 2.28 | 0.9054 | 25 | - | .0016 | .20" Up from bottom |
| 224-2758 | TC2758 | 6 | 3.504 | 89.00 | 8.8:1 | 1.450 | 2.28 | 0.9055 | 3 | - | .0015 | .20" Up from bottom |
| 224-2759 | TC2759 | 6 | 3.800 | 96.50 | 8.5:1 | 1.366 | 2.56 | 0.9054 | 3 | - | .0015 | .50" Up from bottom |

| <u>Rings</u> | <u>Notes</u> |
|------------------------------|--|
| 1-1.75mm, 1-2.00mm, 1-3.00mm | Ricardo Bowl Head. |
| 2-1.50mm, 1-4.00mm | Recessed head .15" deep (For 1987-90 engs.) |
| 2-1.50mm, 1-4.00mm | 2.670" dia. Head recess .200" deep. (1984-85 u.s.a car FWD from 5/83, 1984-87 LD trk. FWD from 5/83; SOHC TURBO 1984-89). |
| 2-1.50mm, 1-2.80mm | Flat head w/4 valve reliefs |
| 2-1.50mm, 1-4.00mm | Recessed head w/4 valve reliefs in recess |
| 1-1.50mm, 1-2.00mm, 1-4.00mm | Recessed head |
| 1-2.50mm, 1-2.00mm, 1-4.50mm | Ricardo Bowl recess w/2 valve reliefs |
| 1-2.50mm, 1-2.00mm, 1-4.50mm | Ricardo Bowl recess w/2 valve reliefs |
| 2-1.50mm, 1-4.00mm | Recessed head 1.2mm deep w/4 valve reliefs. ET2 & A18A1 12V engs. |
| 2-2.00mm, 1-4.00mm | Recessed head 1.50mm deep. Diesel 2L Eng. |
| 1-1.20mm, 1-1.50mm | Flat top w/4 valve reliefs. Celica GTS DOHC, 3SGELC 16 V eng. |
| 2-5/64, 1-3/16 | Flat head w/4 valve reliefs. Not intended for Racing. Destroyed .020" . Same as 224-2770 except Hypereutectic. |
| 2-5/64, 1-3/16 | 3.30" dia. Head recess .270" deep. (32cc). For use with 305 heads. |
| 2-5/64, 1-3/16 | 2.49" dia. Head recess .160" deep. |
| 2-5/64, 1-3/16 | Flat Head. |
| 2-1.50mm, 1-3.0mm | Wedge type head recess, 2 valve reliefs. Escort, CFI. 1996 SEFI, J. Shallow Groove |
| 2-1.50mm, 1-4.0mm | 2.170" dia. Head recess .145" deep w/2 valve reliefs. Non-supercharged. Shallow Groove. |
| 2-1.50mm, 1-3.0mm | Contoured Head. EFI. Not Destroyed. Shallow Groove. |
| 1-1.20mm, 1-1.50mm, 1-3.00mm | Crowned head head recess 2.40" dia., .040" deep w/3 valve reliefs (5.0cc), Festiva. |
| 2-5/64, 1-3/16 | 3.130" dia. Head recess .062" deep. VIN "H". |
| 2-1.50mm, 1-3.00mm | 2.675" dia. Head recess .295" deep, (21cc). EFI, OHV, VIN 1. Small Pin. Olds-J Body. Shallow Groove. |
| 2-1.50mm, 1-4.00mm | 2.57" dia. Head recess .355" deep w/4 valve reliefs. Ford-Probe Turbo. Mazda-Turbo, F2 eng. |
| 2-1.50mm, 1-4.00mm | 2.610" dia head recess .265" deep. Mazda F2 eng. |
| 2-5/64, 1-3/16 | Flat Top w/ 4 valve reliefs. Piston may be used in either Left or Right cyl bank. |
| 2-1.50mm, 1-4.00mm | 2.580" dia. Head recess .020" deep. Mazda 8 valve eng. Ford (1987-89). Mazda (1986-94) |
| 1-1/16, 1-5/64, 1-3/16 | 3.10" dia. head recess .140" deep. Replace in full sets only. Not intended for racing. Destroyed .020". Shallow Groove. |
| 2-5/64, 1-3/16 | D shaped recessed head .300" deep. 1983-95 LD trk. incl. Fuel injection. 1977-82 LD Trk. will replace circular cup piston in complete sets. 1969-76 LD Trk. from change L16 exc. F100. |
| 2-1.50mm, 1-4.00mm | 2.50" dia. Head recess .030" deep with four valve reliefs. |
| 2-1/8, 1-5/32 | Model A. Maximum oversize .060". |
| 1-1.75mm, 1-2.00mm, 1-3.00mm | Ricardo Bowl head. |
| 2-5/64, 1-3/16 | 3.16" dia. Head recess .08" deep 4 valve reliefs, (13cc). Use 1986 & earlier rings. Chevy-Exc. Special High Performance & 1982 Corvette. Oldsmobile-1992-94 Bravada, Olds, Pontiac, Buick-VIN L. |
| 2-5/64, 1-3/16 | Use w/ ring set # 40664CP, 50664CP |
| 1-1.50mm, 1-1.75mm, 1-4.00mm | 2.710" dia head recess, .220" deep. Brazilian eng. |
| 2-5/64, 1-3/16 | 3.265" dia. Head recess, .067" deep. W/Shallow oil ring groove VIN Code "8". |
| 1-1/16, 1-1.75mm, 1-3.5mm | 2.42" dia. head recess .295" deep. Trucks. Passenger cars 1988-89. Shallow Groove |
| 2-1.50mm, 4.00mm | G545B Turbo eng. |
| 2-5/64, 1-3/16 | 3.210" dia. Recessed head .300" deep. From Change L16. |
| 2-1.50mm, 1-4.00mm | Flat Head w/2 valve reliefs. Eng. W/dual spark plug. Up to 1994. |
| 2-5/64, 1-3/16 | 2.00" dia. Head recess .085" deep w/2 valve reliefs. Trk. Eng. Not intended for racing. Destroyed .020". |
| 2-1.50mm, 1-4.00mm | 2.50" dia. Head recess .05" deep w/3 valve reliefs. Late Style ring grooves. G63B, 4G63 SOHC eng. |
| 2-1.22mm, 1-2.82mm | Recessed head. Turbo Spectrum. 4XC1T eng. |
| 1-1.50mm, 1-2.80mm | Non-turbo. 4XC1 eng. |
| 1-1.50mm, 1-1.75mm, 1-3.00mm | Offset recessed head. VolksWagon-RD, HT, UM, JN, GX, PF, RV, 2H. Audi-MG, JN. |
| 1-1.20mm, 1-1.50mm | Recessed head 1.2mm deep w/2 valve reliefs. Geo 1298cc-G13BA eng., Geo 993cc-G10 eng., Suzuki 1324cc-G13A & G13BA eng. |
| 2-5/64, 1-3/16 | Recessed head .14" deep. -Optional Low Comp. Piston-(for late 1969-76 After change L16). |
| 2-1.50mm, 1-4.00mm | Mazda-F2 8V eng. Kia-FE eng. Recessed head 5.4mm deep, w/3 valve reliefs. The larger Relief is the Intake side. |
| 1-3/32, 2-5/64, 1-3/16 | 3/32" step head propane pop-up piston w/ one valve relief. 1985-90 gas trk. Exc. H5D, not destroyed. Use Early style rings. Iron Top Groove. |
| 1-3/32, 2-5/64, 1-3/16 | Off Center Combustion recess w/ one valve relief. Trk. Eng. Not destroyed. Iron Top Groove. |
| 2-3/32, 2-3/16 | Dome head. |
| 2-5/64, 1-3/16 | Recessed head .08" deep w/1 valve relief (For 1984-90 engs.). Iron Top Groove. |
| 2-5/64, 1-3/16 | 3.250" dia. Head recess .130" deep w/2 trough valve reliefs. Use w/ring set# 40564CP, 50564CP |
| 2-5/64, 1-3/16 | 3.250" dia. Head recess .130" deep w/2 trough valve reliefs. Shallow Groove. |
| 2-1.50mm, 1-4.00mm | Contoured Head. EFI. Not Destroyed. Shallow Groove. |
| 2-3/32, 2-3/16 | Dome head. |
| 2-3/32, 2-5/32 | Plymouth Flat Head |
| 2-1.50mm, 1-2.80mm | Recessed head 1.2mm deep, with 4 valve reliefs. Chevy Nova 1587cc, 4AGELC, 16V. Toyota Corolla FX, FX16, FX 16 GTS, MR2. |
| 2-1.50mm, 1-3.00mm | 2.78" dia. Head recess .142" deep. Non-turbo, J Car, VIN K. Shallow Groove. |
| 2-1.50mm, 1-3.00mm | 2.83" dia. Head recess .123" deep. |
| 2-3/32, 1-3/16 | L and F, Flat head. 3 ring piston. |
| 2-1.50mm, 1-4.00mm | 2.88" dia. Head recess .247" deep. For Aluminum Head applications. Use early style rings. |
| 2-1.50mm, 1-4.00mm | 2.95" dia head recess .106" deep. Iron Head. TBI. Chevy-APV only. Olds.-Silhouette, VIN D. Isuzu-Rodeo pickup, VIN Z. |
| 2-1.50mm, 1-3.00mm | 3.10" dia. Head recess .25" deep. Destroyed .020". Shallow Groove. Buick-Riviera, SFI, VIN C. Chevy-Lumina. Olds.-VIN C. Holden-Australian Export. |

| New CEP# | TC # | Set Qty | Bore (in.) | Bore (mm.) | Comp. Ratio | Comp. Height | Piston Length | Pin Diameter | Head Config. | *Mat'l. | Min. Skirt Clearance | Measure Skirt Clearance at: |
|-------------|-----------|---------|------------|------------|-------------|--------------|---------------|--------------|--------------|---------|----------------------|-----------------------------|
| 224-2761 | TC2761 | 6 | 3.800 | 96.52 | 8.5:1 | 1.377 | - | 0.9054 | - | H | .001 | 1.71" from top of head |
| 224-2762 | - | - | 3.7795 | 96.00 | - | 1.577 | 2.83 | 0.9122 | - | H | .0015 | 2.25" from top of head |
| 224-2770 | TC2770 | 8 | 4.000 | 101.60 | 8.8:1 | 1.540 | 3.20 | 0.9273 | 6 | - | .0015 | 15/16" up from bottom |
| 224-2773 | - | - | 3.3858 | 86.00 | 8.8:1 | 1.162 | - | 0.8267 | - | H | .001 | 1.83" from top of head |
| 224-2774 | TC2774 | 4 | 3.5039 | 89.00 | 9.0:1 | 1.170 | 2.00 | 0.8002 | 3 | - | .0015 | bottom of skirt |
| 224-2775 | TC2775 | 8 | 4.250 | 108.00 | 8.75:1 | 1.627 | 2.89 | 0.9898 | 71 | H | .0025 | .55" Up from bottom |
| 224-2777 | - | - | 4.3620 | 110.70 | 8.1:1 | 2.140 | 3.59 | 1.0402 | - | H | .001 | 3.00" from top of head |
| 224-2779 | - | - | 3.5866 | 91.10 | - | 1.395 | 3.05 | 0.8662 | 1 | H | .001 | 2.30" from top of head |
| 224-2781 | - | - | 3.5866 | 91.10 | - | 1.395 | 3.05 | 0.8662 | - | H | .001 | 2.30" from top of head |
| 224-2783 | TC2783 | 4 | 3.4449 | 87.50 | 8.9:1 | 1.350 | 2.125 | 0.9009 | - | - | .0013 | bottom of skirt |
| 224-2788 | TC2788 | 8 | 4.250 | 108.00 | 8.6:1 | 1.645 | 3.210 | 0.990 | - | F | .003 | 1.26" Up from bottom |
| 224-2792 | TC2792 | 4 | 3.4449 | 87.50 | varies | 1.350 | 2.215 | 0.9009 | - | - | - | .50" Up from bottom |
| 224-2795030 | TC2795030 | 8 | 4.000 | 101.60 | - | 1.425 | 2.78 | 0.928 | - | H | .0010 | bottom of pin boss |
| 224-2797 | TC2797 | 8 | 3.622 | 92.00 | 9.5:1 | 1.250 | 2.31 | 0.8662 | 1 | - | - | 1.7" down from top |
| 224-2798 | - | - | 3.6220 | 92.00 | - | 1.627 | 2.72 | 0.8661 | 3 | - | .0015 | 2.31" down from top |
| 224-2800 | - | - | 3.6220 | 92.00 | - | 1.627 | 2.72 | - | - | - | .0015 | 2.31" down from top |
| 224-2801 | - | - | 4.000 | 101.60 | - | 1.542 | 2.72 | 0.9279 | - | H | .0015 | 1.92" from top of head |
| 224-2802 | TC2802 | 6 | 3.5039 | 89.00 | 8.5:1 | 1.598 | 3.05 | 0.9055 | - | - | .001 | 2.36" down from top |
| 224-2803 | TC2803 | 6 | 3.504 | 89.00 | 8.9:1 | 1.608 | 2.48 | 0.9054 | 25 | - | .0015 | .20" Up from bottom |
| 224-2806 | - | - | 3.8110 | 96.80 | - | 1.607 | 2.607 | 0.9122 | 35 | H | .0015 | 1.75" from top of head |
| 224-2808 | - | - | 4.000 | 101.60 | - | 1.784 | - | 0.9122 | - | H | .0015 | 2.08" from top of head |
| 224-2810 | TC2810 | 8 | 4.000 | 101.60 | varies | 1.540 | 2.41 | 0.9273 | 11 | H | .0015 | .20" Up from bottom |
| 224-2811 | TC2811 | 4 | 3.385 | 86.00 | 9.2:1 | 1.171 | 2.12 | 0.8266 | 79 | - | .0015 | .260" Up from bottom |
| 224-2812 | TC2812 | 6 | 3.9535 | 100.40 | 9.0:1 | 1.450 | - | 0.945 | - | H | - | .50" Up from bottom |
| 224-2813 | TC2813 | 8 | 4.000 | 101.60 | 9.0:1 | 1.600 | 2.85 | 0.9122 | 69 | H | .0015 | .60" up from skirt bottom |
| 224-2814 | TC2814 | 6 | 3.777 | 96.00 | varies | 1.369 | 2.22 | 0.9009 | 80 | - | .0015 | .20" Up from bottom |
| 224-2815 | TC2815 | 6 | 3.661 | 93.00 | 8.9:1 | 1.260 | 2.12 | 0.9009 | 80 | - | .0015 | .19" Up from bottom |
| - | TC2816 | 6 | 3.4449 | 87.50 | varies | 1.328 | 2.47 | 0.8271 | - | - | .0012 | .51" Up from bottom |
| 224-2817 | TC2817 | 4 | 3.5827 | 91.00 | 8.8:1 | 1.368 | 2.55 | 0.8665 | - | - | .0020 | .53" Up from bottom |
| 224-2831 | - | - | 3.312 | 84.10 | varies | 1.980 | 3.45 | 0.8593 | 1 | - | .0020 | .250" up from skirt bottom |
| 224-2840 | TC2840 | 6 | 3.562 | 90.50 | 7.7:1 | 2.060 | 3.5 | 0.865 | 1 | - | .0015 | .375" up from skirt bottom |
| 224-2854 | - | - | 3.750 | 95.30 | 7.8:1 | 2.029 | 3.72 | 0.9273 | 1 | - | .0015 | .320" up from skirt bottom |
| 224-2855 | TC2855 | 6 | 3.437 | 87.30 | 6.9:1 | 1.978 | - | 0.8593 | 1 | - | .0020 | bottom of skirt |
| 224-2877 | TC2877 | 8 | 4.094 | 104.00 | 9.6:1 | 1.747 | 3.78 | 0.9898 | 106 | - | .0015 | 1.20" up from skirt bottom |
| 224-2880 | TC2880 | 8 | 4.3600 | 110.70 | 8.9:1 | 1.752 | 3.248 | 1.0402 | 35 | H | .001 | - |
| 224-2881 | TC2881 | 4 | 3.180 | 81.00 | - | 1.203 | 2.400 | 0.7082 | - | - | .0025 | top of skirt slipper |
| 224-2882 | - | 8 | 3.551 | 90.20 | 9.0:1 | 1.210 | - | 0.866 | - | H | .0013 | .567" Up from bottom |
| 224-2883 | - | - | 3.4449 | 87.50 | - | 1.239 | 2.519 | 0.8268 | - | - | 0.0011 | .500" up from skirt bottom |
| 224-2884 | TC2884 | 6 | 4.000 | 101.60 | - | 1.559 | 2.425 | 0.927 | - | H | 0.0014 | .500" up from skirt bottom |
| - | TC2885 | 6 | 3.779 | 96.00 | - | 1.507 | 2.43 | 0.9449 | - | - | 0.0014 | .375" up from skirt bottom |
| 224-2887 | TC2887 | 4 | 3.622 | 92.00 | 9.5:1 | 1.240 | 2.38 | 0.8665 | 69 | H | .0015 | bottom of pin boss |
| 224-2888 | - | - | 3.800 | 96.50 | varies | 1.446 | 2.62 | 0.9054 | 3 | - | .0015 | bottom of pin boss |
| 224-2889 | TC2889020 | 4 | 3.228 | 82.00 | 9.3:1 | 1.165 | 2.07 | 0.768 | 17 | H | .0015 | bottom of pin boss |
| 224-2890 | TC2890 | 4 | 3.228 | 82.00 | 9.5:1 | 1.165 | 2.07 | 0.768 | 84 | H | .0015 | bottom of pin boss |
| 224-2891 | TC2891 | 8 | 4.360 | 110.70 | varies | 1.760 | 3.22 | 1.04 | 35 | - | .0020 | bottom of pin boss |
| 224-2892 | - | - | 2.9724 | 75.50 | varies | 1.133 | 2.28 | 0.709 | 60 | - | .0015 | bottom of pin boss |
| 224-2893 | TC2893 | 4 | 3.1732 | 80.60 | 9.0:1 | 1.320 | 2.67 | 0.7485 | 64 | - | .0015 | bottom of pin boss |
| 224-2894 | TC2894 | 4 | 2.9528 | 75.00 | varies | 1.103 | 2.28 | 0.748 | 82 | - | .0010 | bottom of pin boss |
| 224-2895 | TC2895 | 3 | 2.9134 | 74.00 | varies | 1.120 | 2.18 | 0.6695 | 83 | - | .0013 | bottom of pin boss |
| 224-2896 | TC2896 | 6 | 3.6220 | 92.00 | varies | 1.457 | 2.28 | 0.9054 | 17 | - | - | - |
| 224-2897 | TC2897 | 8 | 4.055 | 103.00 | varies | 2.119 | 3.629 | 1.22 | 18 | - | .004 | 0.63" from bottom |
| 224-2898 | TC2898 | 4 | 3.3465 | 85.00 | 8.8:1 | 1.324 | 2.55 | 0.8665 | 84 | - | .0015 | bottom of pin boss |
| 224-2899 | - | - | 2.953 | 75.00 | 9.6:1 | 1.195 | 2.37 | 0.748 | - | - | .0010 | bottom of pin boss |
| 224-2900 | TC2900 | 4 | 3.517 | 89.30 | 8.5:1 | 39mm | 3.16 | 23mm | 3 | - | .0016 | bottom of pin boss |
| 224-2901 | TC2901 | 6 | 3.625 | 92.00 | 8.3:1 | 1.858 | 3.42 | 0.9122 | 1 | - | .0015 | .312" up from skirt bottom |
| 224-2902 | TC2902 | 4 | 3.646 | 92.60 | varies | 36.5mm | 3.09 | 23mm | 73 | - | .0008 | bottom of pin boss |
| 224-2903 | TC2903 | 8 | 3.625 | 92.00 | 7.8:1 | 1.760 | 3.39 | 0.9122 | 1 | - | .0015 | .531" up from skirt bottom |
| 224-2904 | TC2904 | 8 | 3.750 | 95.30 | 8.6:1 | 1.760 | 3.35 | 0.9122 | 1 | - | .0015 | .550" Up from bottom |
| 224-2905 | TC2905 | 4 | 3.4055 | 86.50 | varies | 1.370 | 2.83 | 0.8267 | 85 | - | - | - |
| - | TC2906 | 6 | 3.586 | 91.10 | 8.85:1 | 1.247 | 2.58 | 0.8665 | 87 | - | .0015 | bottom of pin boss |
| 224-2907 | TC2907 | 8 | 4.000 | 101.60 | varies | 1.605 | 3.24 | 0.9842 | 46 | - | .0015 | bottom of pin boss |
| 224-2908 | TC2908 | 8 | 4.110 | 104.40 | varies | 1.950 | 3.46 | 1.11 | 88 | - | .0055 | 1.00" up from skirt bottom |
| 224-2909 | TC2909 | 4 | 3.4055 | 86.50 | varies | 1.360 | - | 0.8665 | 89 | - | - | - |
| 224-2911 | TC2911 | - | 3.110 | 79.00 | - | 1.102 | - | 0.7087 | - | - | 0.0009 | .312" up from skirt bottom |

*H = Hypereutectic

| <u>Rings</u> | <u>Notes</u> |
|------------------------------|--|
| 2-1.50mm, 1-3.00mm | 3.050" dia. Head recess .260" deep. VIN C & L. Also 1988-91 Holden 3791cc. |
| 2-2.00mm, 1-4.76mm | Recessed head w/offset D shaped .095" deep. |
| 2-5/64, 1-3/16 | Flat Head w/ 4 Valve reliefs, 5.9cc. Truck & Pass. Same as 224--2511 except cast aluminum. |
| 2-1.50mm, 1-3.00mm | 2.785" dia. Head recess .130" deep. VIN K. |
| 2-1.50mm, 1-3.00mm | 2.94" dia. Head recess .215" deep. Chevy-VIN G 1990-91, 92-94 VIN 4 TBI, EFI. |
| 2-5/64, 1-3/16 | 2.00" dia. Head recess .05" deep w/2valve reliefs. L19 engine. Destoked .020". Shallow Groove. |
| 1-3/32, 1-5/64, 1-3/16 | Flat head w/2 valve reliefs. |
| 2-1.50mm, 1-4.00mm | Flat head. Mitsubishi-G54B. |
| 2-2.00mm, 1-4.00mm | 2.670" dia. Head recess .130" deep. NOT AN O.E. DUPLICATE. Replace in Sets. |
| 2-1.50mm, 1-4.00mm | 3.07" dia. Head recess .135" deep w/2 valve reliefs. VIN K. Press Fit Pin. Shallow Groove. |
| 2-5/64, 1-3/16 | Dome head .095" high w/2 Radius valve reliefs & 1 flat relief. Special High Performance Forged Piston. |
| 2-1.50mm, 1-4.00mm | 2.8" dia. Head recess .280" deep w/2 valve reliefs. Turbo. Full floating Pin. Shallow Groove. |
| 2-5/64, 1-3/16 | Flat head w/4 valve reliefs. High Performance Piston. Comes with lockrings. |
| 2-1.50mm, 1-3.00mm | Flat Head. 273 cid & 298cid - 3534204 & 3526531 sleeve. 298 cid-Non-Turbo. L26 eng. |
| 2-1.50mm, 1-3.00mm | 2.940" dia. Head recess .062" deep. Cadillac Allante w/VIN 8. |
| 2-1.50mm, 1-3.00mm | 2.940" dia. Head recess .020" deep. Exc. Cadillac Allante. |
| 2-5/64, 1-3/16 | Raised Head .150" deep x 3.260" dia. w/2 valve reliefs. (72-90) Optional for engs. w/68-76cc heads, 305 heads or alum. Corvette heads. (91-96) VIN code "K" w/deep oil ring groove, P3 & G3 series w/Heavy Duty Emmissions. Syclone/Typhoon. |
| 2-1.50mm, 1-4.00mm | 2.66" dia, head recess .250" deep w/shallow oil ring groove - low tension ring. VIN W. |
| 2-1.50mm, 1-4.00mm | 2.47" dia. Head recess .27" deep. E.F.I., J Body. Shallow Groove. |
| 2-1.50mm, 1-4.00mm | Recessed Head .170" deep with S/C eng. |
| 2-1.50mm, 1-4.00mm | Rectangular Head recess .190" deep. 1993-96 F150 Lightning. 1997 LD Trk. |
| 1-2.00mm, 1-1.5mm, 1-4.00mm | Flat Head w/4 valve reliefs. Piston destoked .020". Cad.-Brougham. Chevy-Corvette. Pontiac-Firebird. |
| 2-1.50mm, 1-3.00mm | 2.23" dia. Offset head recess .190" deep, (11cc). Sunbird, non-turbo. |
| 1-1.60mm, 1-1.75mm, 1-3.50mm | 2.4" dia. Head recess, .305" deep. |
| 2-1.50mm, 1-4.00mm | 2.45" dia. Head recess .030" deep w/4valve reliefs. High Output. Destoked .020". Shallow Groove. |
| 2-1.50mm, 1-3.00mm | Oval head recess .192" deep, (16cc). Code L. |
| 2-1.50mm, 1-3.00mm | Oval Head recess .09" deep. Eagle-Vision. SEFI, OHC. Chrysler-MEFI, OHC. |
| 2-1.50mm, 1-4.00mm | Head recess .124" deep w/2 valve reliefs. 3VZE eng. |
| 2-1.50mm, 1-4.00mm | head recess .240" deep. 4YEC engine. |
| 2-3/32, 2-5/32 | Flat head. F6226 engines. |
| 2-3/32, 1-3/16 | Flat head. |
| 2-3/32, 1-3/16 | Flat head. Truck eng. |
| 2-3/32, 2-5/32 | Flat Head. Desoto. Chrysler. Dodge trk. |
| 2-5/64, 1-3/16 | Used in either right or left cylinder bank. 3/16" high crown. |
| 2-5/64, 1-3/16 | Oblong, recessed head .065" deep. |
| 2-1.50mm, 1-2.80mm | Butterfly shaped recessed head. 4AF & 4AFE engs. 4AGEC, 4AGELC. Use with part number 41482. |
| 2-1.50mm, 1-3.00mm | .157" Recessed Head. 91-94 (Romeo Engine Only). Press Fit pin only. 10.5cc recess. |
| 2-1.20mm, 1-3.00mm | Domed w/4 valve reliefs. |
| 1-2.00mm, 1-1.50mm, 1-4.00mm | Dish recess .073" deep w/4 valve reliefs |
| 2-1.50mm, 1-3.00mm | Replace in Complete sets. Comp. Height does not include .08mm pop up. |
| 2-1.50mm, 1-3.00mm | 2.66" dia. Head recess .150" deep w/4 valve reliefs. SOHC. Quad-4 engine, incl. HO. Olds.-Acheiva. |
| 1-1.20mm, 1-1.50mm, 1-3.00mm | 3.10" dia. Head recess .295" deep. Shallow Groove. Buick-VIN L. Except supercharged. Chevy-Lumina APV. |
| 2-1.50mm, 1-3.00mm | 2.00" dia. Head recess .220" deep. VIN 9. |
| 2-1.50mm, 1-3.00mm | DOHC. 2.70" dia. Head recess .110" deep w/2 valve reliefs. Use early sty ring pick. VIN 7 |
| 2-2.00mm, 1-4.00mm | Oval head recess .180" deep w/2 valve reliefs. Screw Type PCV. Truck or Van eng. |
| 1-1.20mm, 1-1.50mm, 1-3.00mm | 2.56" dia. Head recess .02" deep. Colt. 4G15 eng. |
| 2-1.50mm, 1-4.00mm | .150" dome with 2 valve reliefs. 4G37 eng. Eagle-Talon. |
| 1-1.20mm, 1-1.50mm, 1-2.80mm | 2.346" dia. Head recess .120" deep w/2 valve reliefs. G16KC eng. Exc. California. Geo Tracker, TBI, VIN Q. Suzuki Sidekick G16KC engine, TBI VIN O. |
| 1-1.2mm, 1-1.5mm, 1-2.8mm | Recessed head w/2 valve reliefs 3 ring piston. Suzuki-G10 eng. Sprint, Mark 1-MS, except LSI. Geo-metro, except LSI, FXI. G10 eng. |
| 2-1.50mm, 1-4.00mm | 2.75" dia. Head recess .080" deep. VIN S. Camaro & Firebird. |
| 1-3.00mm, 1-2.00mm, 1-4.00mm | Flat head with Ricardo recess .158" deep. Hard Anodized Head. Ni Resist Ring Carrier. Diesel Turbo and Non-Turbo, HO. |
| 2-1.20mm, 1-2.80mm | 2.84" dia. Head recess .130" deep w/4 valve reliefs. F22A1 eng. Accord all exc. SE. |
| 1-1.20mm, 1-1.50mm, 1-2.80mm | Flat head w/4 valve reliefs. D15B1/D15B2/D15B6 Civic, CRX OHC eng. |
| 2-1.50mm, 1-4.00mm | Recessed head 4.3mm deep. Isuzu-4ZD1 eng. |
| 2-3/32, 1-3/16 | Flat Head. |
| 2-1.50mm, 1-4.00mm | Recessed head 1.4mm deep. 4ZE1 Isuzu eng. |
| 2-3/32, 1-3/16 | Flat Head. |
| 2-5/64, 1-3/16 | Flat Head. |
| 2-1.50mm, 1-4.00mm | Flat head w/3 valve reliefs. SOHC. Mitsu.- Pickup & Expo. Dodge-RAM 50. Eagle-Summit 1992 116 HP, 1993 136Hp. Dodge Vista |
| 1-1.20mm, 1-1.50mm, 1-3.00mm | Triangular head recess .105" deep w/2 valve reliefs. 6G72 & SOHC 6G72S engs. |
| 2-1.5mm, 1-4.00mm | Rectangular head recess .070" deep. Trucks. JEEP-Grand Cherokee. |
| 1-3.00mm, 1-2.00mm, 1-3.50mm | Swirl Chamber. Truck Diesel. Non-Turbo, not destoked. Iron Top Groove. |
| 1-1.20mm, 1-1.50mm, 1-2.80mm | Circular 3.10" dia. Head recess .150" deep. 4G64 eng. Mitsu.-1994 E56A Galant, DOHC. Dodge-Vista, Eagle-Summit. |
| 1-1.20mm, 1-1.50mm, 1-3.00mm | Recessed head .153" deep. |

| New CEP# | TC # | Set Qty | Bore (in.) | Bore (mm.) | Comp. Ratio | Comp. Height | Piston Length | Pin Diameter | Head Config. | *Mat'l. | Min. Skirt Clearance | Measure Skirt Clearance at: |
|----------|-----------|---------|------------|------------|-------------|--------------|---------------|--------------|--------------|---------|----------------------|-----------------------------|
| 224-2912 | TC2912 | 4 | 3.1890 | 81.00 | 9.5:1 | 1.195 | 2.35 | 0.7485 | 60 | - | - | - |
| 224-2913 | TC2913020 | 8 | 3.800 | 96.50 | 9.5:1 | 1.760 | 3.35 | 0.9122 | 1 | - | .0015 | .500" up from skirt bottom |
| 224-2914 | TC2914 | 8 | 4.250 | 108.00 | 9.0:1 | 1.627 | 3.37 | 0.9898 | 81 | H | .0020 | 1.00" up from skirt bottom |
| 224-2915 | TC2915 | 6 | 3.622 | 92.00 | 9.3:1 | 1.457 | 2.27 | 0.9055 | 11 | - | .0015 | .250" up from skirt bottom |
| 224-2916 | TC2916 | 4 | 3.5039 | 89.00 | 9.0:1 | 1.170 | 2.00 | 0.8002 | 3 | - | - | - |
| 224-2917 | TC2917 | 4 | 3.3900 | 86.00 | - | 1.358 | 2.80 | 0.8650 | - | - | .0010 | top of skirt slipper |
| 224-2921 | TC2921 | 4 | 2.992 | 76.00 | - | 29mm | 2.126 | 19mm | - | - | .0012 | top of skirt slipper |
| 224-2922 | TC2922 | 4 | 3.5039 | 89.00 | 8.6:1 | 33.7mm | 2.697 | 21mm | 4 | - | .0012 | top of skirt slipper |
| 224-2923 | TC2923 | 4 | 3.5039 | 89.00 | 8.6:1 | 34mm | 2.677 | 21mm | 3 | - | .0008 | top of skirt slipper |
| - | TC2924 | 4 | 2.9913 | 74.00 | 9.2:1 | 29.5mm | 2.362 | 19mm | 88 | - | .0012 | top of skirt slipper |
| 224-2925 | TC2925 | 4 | 3.258 | 82.75 | varies | 30mm | 2.571 | 20mm | 47 | - | .0012 | top of skirt slipper |
| 224-2927 | TC2927 | 4 | 2.953 | 75.00 | 9.6:1 | 1.195 | 2.37 | 0.748 | 11 | - | .0010 | top of skirt slipper |
| 224-2928 | TC2928 | 4 | 3.5157 | 88.00 | - | 1.487 | 3.150 | 0.8658 | - | - | .0018 | top of skirt slipper |
| 224-2929 | TC2929 | 6 | 3.543 | 90.00 | 8.5:1 | 35.4mm | 2.913 | 23mm | 90 | - | .0019 | top of skirt slipper |
| 224-2930 | TC2930 | 4 | 3.346 | 85.00 | 9.0:1 | 34.5mm | 2.637 | 21mm | 93 | - | .0015 | top of skirt slipper |
| 224-2932 | TC2932 | 4 | 3.386 | 86.00 | 9.3:1 | 35mm | 2.693 | 20mm | 92 | - | .0022 | top of skirt slipper |
| 224-2933 | TC2933 | 6 | 3.268 | 83.00 | 9.2:1 | 33mm | 2.795 | 22mm | 95 | - | .001 | top of skirt slipper |
| 224-2934 | TC2934 | 6 | 3.268 | 83.00 | 8.4:1 | 33mm | 2.795 | 22mm | 96 | - | .0015 | top of skirt slipper |
| 224-2935 | TC2935 | 6 | 3.445 | 87.50 | 9.0:1 | 32mm | 2.559 | 21mm | 78 | - | .0022 | top of skirt slipper |
| 224-2938 | TC2938 | 4 | 2.873 | 73.00 | 9.3:1 | 1.167 | 2.46 | 18mm | 97 | - | .002 | top of skirt slipper |
| 224-2940 | TC2940 | 8 | 4.250 | 108.00 | 9.5:1 | 1.750 | 3.74 | 0.9898 | 106 | - | .0015 | 1.20" Up from bottom |
| 224-2944 | TC2944 | 6 | 3.800 | 96.50 | 8.5:1 | 1.805 | 2.98 | 0.9398 | 3 | H | .0015 | bottom of skirt |
| - | TC2946 | 6 | 3.586 | 91.10 | varies | 1.247 | 2.67 | 0.8665 | 87 | - | .0015 | .70" Up from bottom |
| 224-2947 | TC2947 | 6 | 3.661 | 93.00 | 9.3:1 | 1.510 | - | 0.9842 | 1 | - | .0020 | top of skirt slipper |
| 224-2948 | TC2948 | 8 | 4.000 | 101.60 | varies | 1.540 | 3.20 | 0.9273 | 91 | H | .0015 | - |
| - | TC2948A | 6 | 4.000 | 101.60 | varies | 1.540 | 3.20 | 0.9273 | 91 | H | .0015 | .90" Up from bottom |
| 224-2975 | TC2975 | 4 | 3.339 | 84.82 | - | 1.301 | - | 20.63mm | - | - | .0012 | .394" from bottom |
| 224-2976 | TC2976 | 4 | 3.150 | 80.00 | 9.1:1 | 1.102 | 2.441 | 18mm | 11 | - | .0028 | top of skirt slipper |
| 224-2977 | TC2977 | 4 | 3.2677 | 83.00 | - | 1.203 | 2.400 | 0.7871 | - | - | 0.0012 | top of skirt slipper |
| 224-2978 | TC2978 | 4 | 3.150 | 80.00 | - | 1.124 | 2.520 | 0.7082 | - | - | .0013 | top of skirt slipper |
| 224-2979 | TC2979 | 4 | 2.953 | 75.00 | - | 1.136 | 2.180 | 0.7730 | - | - | .0012 | top of skirt slipper |
| 224-2980 | TC2980 | 4 | 3.240 | 82.30 | - | 1.288 | 2.545 | 0.8266 | - | - | .0012 | top of skirt slipper |
| 224-2981 | TC2981 | 4 | 2.953 | 75.00 | - | 1.149 | 2.335 | 0.7480 | - | - | .0012 | top of skirt slipper |
| 224-2982 | TC2982 | 4 | 3.622 | 92.00 | - | 1.442 | 2.930 | 0.9045 | - | - | .0012 | top of skirt slipper |
| 224-2983 | TC2983 | 4 | 2.992 | 76.00 | - | 1.154 | 2.120 | 0.7480 | - | - | .0012 | top of skirt slipper |
| 224-2984 | TC2984 | 4 | 3.385 | 86.00 | - | 1.261 | 2.48 | 0.8658 | 1 | - | .0012 | top of skirt slipper |
| 224-2985 | TC2985 | 4 | 3.504 | 89.00 | - | 1.323 | 2.67 | 0.8264 | - | - | .0012 | top of skirt slipper |
| 224-2986 | TC2986 | 4 | 3.425 | 87.00 | - | 1.283 | 2.48 | 0.866 | - | - | .0012 | top of skirt slipper |
| 224-2987 | TC2987 | 4 | 2.953 | 75.00 | - | 1.183 | 2.365 | 0.7476 | - | - | .0012 | top of skirt slipper |
| 224-2988 | TC2988 | 4 | 3.346 | 85.00 | - | 1.373 | 2.63 | 0.826 | - | - | .0008 | top of skirt slipper |
| 224-2989 | TC2989 | 4 | 3.189 | 81.00 | - | 1.198 | 2.54 | 0.7875 | - | - | .0012 | .375" up from skirt bottom |
| 224-2990 | TC2990 | 8 | 4.050 | 102.90 | 7.21 | 1.882 | 3.88 | 0.9752 | 39 | - | .0020 | .875" Up from bottom |
| 224-2991 | TC2991 | 8 | 3.8976 | 99.00 | - | 1.339 | - | 0.945 | 1 | - | .001 | .400" from bottom |
| 224-2992 | TC2992 | 8 | 4.000 | 101.60 | varies | 1.605 | 3.35 | 0.9122 | 42 | H | .0015 | 1.100" Up from bottom |
| 224-3050 | TC3050 | 4 | 3.405 | 86.50 | 8.5:1 | 35.00mm | 2.811 | 21mm | 101 | - | .0012 | - |
| - | TC3056 | 8 | 4.000 | 101.60 | 7.5:1 | 1.570 | 3.27 | 0.9273 | 102 | - | .0015 | Bottom of pin boss |
| - | TC3057 | 8 | 3.800 | 96.50 | 8.0:1 | 1.605 | 3.60 | 0.9805 | 103 | - | .0015 | Bottom of pin boss |
| 224-3058 | TC3058 | 4 | 2.953 | 75.00 | 9.2:1 | 30mm | 2.402 | 19mm | 11 | - | .0008 | - |
| 224-3061 | TC3061 | 6 | 4.130 | 104.90 | 10.3:1 | 1.660 | - | 0.9752 | 15 | - | .0015 | Bottom of pin boss |
| 224-3062 | TC3062 | 8 | 4.000 | 101.60 | 8.5:1 | 1.635 | 3.24 | 0.9122 | 104 | - | .0015 | Bottom of pin boss |
| 224-3064 | TC3064 | 6 | 3.6614 | 93.00 | varies | 1.535 | 2.89 | 0.9450 | 1 | - | .0015 | Bottom of pin boss |
| 224-3065 | TC3065 | 4 | 3.7795 | 96.00 | 8.7:1 | 1.578 | 2.98 | 0.9122 | 8 | - | .0015 | Bottom of pin boss |
| 224-3066 | TC3066 | 8 | 4.000 | 101.60 | 9.0:1 | 1.576 | 3.16 | 0.9842 | 1 | - | .0015 | Bottom of pin boss |
| - | TC3072 | 4 | 4.000 | 101.60 | 8.2:1 | 1.570 | 3.26 | 0.9273 | 3 | - | .0025 | Bottom of pin boss |
| 224-3075 | TC3075 | 8 | 4.300 | 109.00 | 8.5:1 | 2.004 | 3.76 | 0.9997 | 26 | - | .0010 | Bottom of pin boss |
| 224-3076 | TC3076 | 8 | 4.300 | 109.00 | 8.5:1 | 1.883 | 3.28 | 0.9997 | 26 | - | .0010 | Bottom of pin boss |
| 224-3078 | TC3078 | 8 | 3.6614 | 93.00 | 10.3:1 | 1.250 | - | 0.8665 | 11 | - | - | - |
| 224-3079 | TC3079 | 8 | 4.050 | 102.90 | 7.2:1 | 1.760 | 4.167 | 0.9752 | 39 | - | .0020 | Bottom of pin boss |
| 224-3082 | TC3082 | 6 | 4.000 | 101.60 | varies | 1.778 | 3.17 | 0.9752 | - | H | .0015 | Bottom of pin boss |
| 224-3086 | TC3086030 | 6 | 3.313 | 84.10 | varies | 2.000 | - | 0.8593 | 1 | - | .0015 | Bottom of pin boss |
| 224-3089 | TC3089 | 4 | 3.622 | 92.00 | varies | 35mm | 2.52 | 22mm | 60 | - | .0015 | - |
| 224-3097 | TC3097 | 8 | 4.360 | 110.70 | 8.1:1 | 1.772 | 3.74 | 1.040 | 35 | H | .0015 | Bottom of pin boss |
| 224-3098 | TC3098 | 6 | 4.000 | 101.60 | 8.3:1 | 1.778 | 3.17 | 0.9752 | - | H | .0015 | Bottom of pin boss |

*H = Hypereutectic

| <u>Rings</u> | <u>Notes</u> |
|------------------------------|---|
| 2-1.20mm, 1-2.80mm | Flat head w/2 valve reliefs. 1834cc 4G93 eng. Eagle-Summit, 113HP. |
| 1-5/64, 1-3/32, 1-3/16 | Flat Head. |
| 2-5/64, 1-3/16 | Flat head w/2 valve reliefs. Used in either right or left cyl. Banks. Not intended for racing applications. Destroyed .020. |
| 2-1.50mm, 1-4.00mm | Flat head w/4 valve reliefs. DOHC. Used in either left or right cylinder bank. Used in sets with early style rings. Pontiac-Grand Prix. |
| 2-1.50mm, 1-3.00mm | Circular 2.94" dia. Head recess .200" deep. 19cc dish vol. VIN 4. Pass. & trk. Chevy-Also 1993 Lumina. Olds.-Cutlass Ciera. Pontiac-Sunfire. |
| 2-1.50mm, 1-4.00mm | Recessed Head w/3 valve reliefs. |
| 2-1.50mm, 1-2.80mm | Bowl Shaped recess 4.8mm deep. |
| 2-1.50mm, 1-2.80mm | Recessed head 0.6mm deep. KA24E 12V eng. |
| 2-1.50mm, 1-2.80mm | Recessed head 0.5mm deep. KA24E 12V eng. |
| 2-1.2mm, 1-2.8mm | Shaped recessed head. 4.5mm deep with 1 valve relief. SETS ONLY. D15A2 eng. |
| 2-1.50mm, 1-4.00mm | Recessed head 2.3mm deep w/4 valve reliefs. A20A3, BS2, BT engs. |
| 1-1.2mm, 1-1.5mm, 1-2.8mm | Flat head w/4 valve reliefs. D15B1/D15B2/D15B6 Civic, CRX OHC eng. |
| 2-1.50mm, 1-4.00mm | Recessed head. 4ZC1 eng. |
| 2-1.50mm, 1-4.00mm | Recessed Head 3.6mm deep w/3 valve reliefs. JEO6, JEO7, JE, JE39 18V engs. Coated Skirt. |
| 1-1.20mm, 1-1.50mm, 1-3.00mm | Recessed head 2.38mm deep w/4 valve reliefs. 4G63, A, G4CP, DOHC 16V engs. |
| 2-1.50mm, 1-4.00mm | 3SFE 16V eng. |
| 2-1.50mm, 1-4.00mm | Special shaped head recess 3.2mm deep w/4 valve reliefs. 7MGE 24V eng. |
| 2-1.50mm, 1-4.00mm | Recessed head 5.8mm deep w/4 valve reliefs. 7MGTE 24V eng. |
| 2-1.50mm, 1-3.00mm | Recessed head 2mm deep. W/4 valve reliefs. Toyota-2VZFE 24V eng., (Lexus ES250 1990-91). |
| 2-1.50mm, 1-3.00mm | Special Shaped Head Recess. 3EE Tercel eng. |
| 2-5/64, 1-3/16 | .140" crown. Used in either left or right cylinder bank |
| 2-5/64, 1-3/16 | 3.05" dia. Head recess .235" deep. Destroyed .020". Non-turbo. VIN A. |
| 2-1.50mm, 1-4.00mm | Triangular head recess .108" deep w/2 valve reliefs. Chrysler-6G72 eng. Stealth, SOHC. Hyundai-G6AT Sonata, EFI |
| 2-1.50mm, 1-4.00mm | Flat Head. VIN U. |
| 2-5/64, 1-3/16 | 3.14" dia. Head recess .07" deep w/4 valve reliefs, (12cc). Use 1986 & earlier rings. Not intended for racing applications. Destroyed .020" GMC Trk.-Deep Groove. |
| 2-5/64, 1-3/16 | (same as 2948. see above.) |
| 1-1.50mm, 1-1.75mm, 1-3.00mm | Dome head 1.26mm high, with valve reliefs, 2 are 5.23mm deep, and one is 6.47mm deep. |
| 2-1.20mm, 1-3.00mm | Flat Head w/ 4 valve reliefs. RF 12V Geo Storm eng. Isuzu Stylus 4XE1 12V eng. |
| 2-1.50mm, 1-3.00mm | Raised head with 4 valve reliefs. |
| 2-1.20mm, 1-3.00mm | Raised head w/ 4 valve reliefs. |
| 1-1.20mm, 1-1.50mm, 1-2.80mm | Recessed head w/4 valve reliefs in recess. |
| 1-1.20mm, 1-1.50mm, 1-3.00mm | Raised head with 4 valve reliefs. |
| 1-1.20mm, 1-1.50mm, 1-2.80mm | Recessed head w/4 valve reliefs in recess. |
| 2-1.50mm, 1-4.00mm | Concave head. |
| 2-1.50mm, 1-2.80mm | Concave head. |
| 2-1.50mm, 1-3.00mm | Flat Head. |
| 2-1.50mm, 1-2.80mm | Concave head. |
| 2-1.50mm, 1-4.00mm | Recessed head w/4 valve reliefs. |
| 1-1.20mm, 1-1.50mm, 1-2.80mm | Raised head w/ 4 valve reliefs. |
| 1-1.20mm, 1-1.50mm, 1-3.00mm | Recessed head w/4 valve reliefs in recess. Turbo 4G63 eng. |
| 1-1.20mm, 1-1.50mm, 1-2.80mm | Raised head w/4 valve reliefs. |
| 1-3/32, 1-5/64, 1-3/16 | 2.6" dia. Head recess .17" deep. 359/361 Trk. Eng. After Engine U40000. 3 rings. |
| 2-1.50mm, 1-3.00mm | Flat head w/ reliefs |
| 2-5/64, 1-3/16 | Flat top w/4 valve reliefs. Not intended for racing applications. Not destroyed. |
| 2-1.50mm, 1-4.00mm | Recessed head .38mm deep w/ 3 valve reliefs. Hyundai Sonata G4CS eng., Mitsu-Expo 4G84 8V eng., Mitsu-Galant & Van G64B eng., Chrysler-Colt Vista T & 4G64 eng., Chrysler-RAM 50, Power Ram 50 pickup T & 4G64 eng. |
| 2-5/64, 1-3/16 | LU8 eng., Turbo. Shallow Groove. Right & Left cyl. Bank set. |
| 2-5/64, 1-3/16 | Recessed head .270" deep. Left and right cyl. Bank set. |
| 1-1.20mm, 1-1.50mm, 1-2.80mm | Flat head w/ 4 valve reliefs. D15B1 16V Civic eng. |
| 2-5/64, 1-3/16 | 2.593" dia. Head recess .125" deep w/4 valve reliefs. Pin I.D. .70" Cobra Jet. |
| 2-5/64, 1-3/16 | Flat head with 2 angled valve reliefs. Cleveland eng. |
| 1-2.0mm, 1-2.5mm, 1-4.00mm | Flat head. Capri, Mustang II (1976-79), Ranger (1983-85) |
| 2-1.5mm, 1-4.00mm | Flat Head w/2 valve reliefs. Shallow Groove. |
| 2-5/64, 1-3/16 | Flat head. |
| 2-5/64, 1-3/16 | 3.02" dia. Head recess .226" deep. Replace in full sets only. Chevy-Citation. Buick-Skylark. |
| 2-5/64, 1-3/16 | Rectangular head recess .380" deep. |
| 2-5/64, 1-3/16 | Head recess 13/32" deep. 50cc dish. |
| 2-1.5mm, 1-3.00mm | Flat head w/4 valve reliefs. Cadillac North Star System. Chevy-Camaro Z28. Cad.-VIN 9 and Y. L37 eng. 270 and 295 HP. |
| 1-3/32, 2-5/64, 1-3/16 | 3" dia. Head recess .31" deep. Iron Top Groove. Can be replaced by 224--2004. Truck eng., not destroyed. |
| 2-5/64, 1-3/16 | 2.7" dia. Head recess .215" deep. Special Heavy UPS type service. |
| 1-5/64, 2-3/32, 1-1/4 | F226 & F227 engines. Flat Head. |
| 2-1.50mm, 1-4.00mm | Recessed Head 2.2mm deep w/1 valve relief. |
| 2-5/64, 1-3/16 | .240" deep w/2 valve reliefs. Car & trk. Non-EFI. Not destroyed. |
| 2-5/64, 1-3/16 | 3.0" dia. Head recess .240" deep. Special step quench head for heavy UPS type service. |

| New CEP# | TC # | Set Qty | Bore (in.) | Bore (mm.) | Comp. Ratio | Comp. Height | Piston Length | Pin Diameter | Head Config. | *Mat'l. | Min. Skirt Clearance | Measure Skirt Clearance at: |
|----------|---------|---------|------------|------------|-------------|--------------|---------------|--------------|--------------|---------|----------------------|-----------------------------|
| 224-3099 | TC3099 | 8 | 3.551 | 90.20 | varies | 1.200 | 2.19 | 0.8665 | 4 | H | .0015 | Bottom of pin boss |
| 224-3101 | TC3101 | 8 | 3.937 | 100.00 | varies | 2.160 | 3.41 | 0.9898 | - | H | .0020 | Bottom of pin boss |
| 224-3107 | - | 4 | 3.875 | 98.40 | 4.2:1 | 1.906 | - | 0.9997 | 1 | - | .0020 | Bottom of pin boss |
| 224-3108 | TC3108 | 4 | 3.1732 | 80.60 | 8.2:1 | 1.455 | - | 0.8662 | - | - | - | - |
| 224-3110 | TC3110 | 4 | 3.779 | 96.00 | varies | 46.40mm | 3.007 | 24mm | 1 | - | .0004 | 3.25" below centerline |
| 224-3118 | TC3118 | 6 | 3.267 | 83.00 | 8.9:1 | 38mm | 2.559 | 20mm | 3 | - | .0004 | 3.25" below centerline |
| 224-3120 | TC3120 | 4 | 3.425 | 87.00 | 8.5:1 | 35.50mm | 2.397 | 21mm | 47 | - | .0012 | 3.25" below centerline |
| 224-3123 | TC3123 | 6 | 3.875 | 98.40 | 7.2:1 | 1.935 | 3.62 | 0.9273 | 19 | - | .0025 | Bottom of pin boss |
| 224-3129 | TC3129 | 4 | 3.228 | 82.00 | varies | 1.474 | 2.68 | 0.9055 | 1 | - | .0010 | Bottom of pin boss |
| 224-3132 | TC3132 | 8 | 3.500 | 88.90 | 9.6:1 | 1.843 | 3.03 | 0.8750 | 3 | - | .0015 | Bottom of pin boss |
| 224-3133 | TC3133 | 4 | 3.622 | 92.00 | 9.0:1 | 1.536 | 3.64 | 0.8665 | - | H | .0015 | Bottom of pin boss |
| 224-3134 | TC3134 | 4 | 2.9134 | 74.00 | 8.2:1 | 1.100 | 2.181 | 0.6692 | 86 | - | .0012 | - |
| 224-3163 | TC3163 | 8 | 4.110 | 104.40 | varies | 2.142 | 3.789 | 1.3085 | - | - | .0055 | .850" from bottom |
| 224-3173 | TC3173 | 8 | 4.125 | 104.80 | varies | 1.747 | 3.720 | 0.9898 | 106 | - | .0015 | Bottom of pin boss |
| 224-3174 | TC3174 | 4 | 3.586 | 91.10 | 8.2:1 | 1.365 | 3.02 | 0.8665 | 3 | H | .0015 | Bottom of pin boss |
| 224-3175 | TC3175 | 6 | 4.000 | 101.60 | varies | 1.540 | 2.42 | 0.9273 | 91 | H | .0015 | Bottom of pin boss |
| - | TC3175A | 8 | 4.000 | 101.60 | varies | 1.540 | 2.42 | 0.9273 | 91 | H | .0015 | Bottom of pin boss |
| 224-3176 | TC3176 | 6 | 3.800 | 96.50 | - | 1.446 | - | 0.9054 | 3 | H | .0015 | Bottom of pin boss |
| 224-3177 | TC3177 | 6 | 4.000 | 101.60 | 8.7:1 | 1.780 | 3.38 | 0.9752 | 13 | - | 4.000 | Bottom of pin boss |
| 224-3178 | TC3178 | 4 | 3.586 | 91.10 | 8.2:1 | 1.418 | 3.07 | 0.8665 | 1 | - | .0015 | Bottom of pin boss |
| 224-3179 | TC3179 | 4 | 3.425 | 87.00 | varies | 1.438 | 3.13 | 0.8665 | 1 | - | .0015 | Bottom of pin boss |
| 224-3180 | TC3180 | 8 | 4.360 | 110.70 | varies | 1.760 | 3.27 | 1.04 | 35 | - | .0015 | Bottom of pin boss |
| 224-3181 | TC3181 | 4 | 3.5039 | 89.00 | 9.0:1 | 1.170 | - | 0.8002 | 16 | H | - | Bottom of pin boss |
| 224-3183 | TC3183 | 8 | 4.110 | 104.39 | - | 1.950 | 3.46 | 1.3085 | - | - | .006 | 1.00" from bottom |
| 224-3184 | TC3184 | 8 | 3.910 | 99.31 | - | 1.730 | 3.435 | 0.984 | 1 | - | .0010 | 1.00" Up from bottom |
| 224-3287 | TC3287 | 4 | 3.438 | 87.30 | varies | 1.998 | - | 0.8593 | 1 | - | .0020 | Bottom of pin boss |
| 224-3401 | TC3401 | 4 | 3.6220 | 92 | 7.5:1 | 1.355 | 2.49 | 0.8665 | - | - | .0025 | Bottom of pin boss |
| 224-3402 | TC3402 | 8 | 4.000 | 101.6 | 9.1:1 | 1.54 | 2.42 | 0.9273 | 91 | H | .0015 | Bottom of pin boss |
| - | TC3402A | 6 | 4.000 | 101.6 | 9.1:1 | 1.54 | 2.42 | 0.9273 | 91 | H | .0015 | Bottom of pin boss |
| 224-3403 | TC3403 | 8 | 4.054 | 102.981 | - | 2.109 | 3.619 | 1.22 | - | H | .004 | .63" from bottom |
| 224-3404 | TC3404 | 6 | 3.8122 | 96.83 | 9.3:1 | 1.255 | 2.55 | 0.9054 | - | H | .0017 | Bottom of pin boss |
| 224-3405 | TC3405 | 4 | 3.445 | 87.5 | 9.8:1 | 1.23 | 2.52 | 0.8267 | - | - | .0010 | - |
| 224-3406 | TC3406 | 6 | 3.38 | 86 | - | 1.222 | 2.0965 | 0.8662 | 1 | H | - | 1.66" Down from top |
| 224-3407 | TC3407 | 6 | 3.7992 | 96.5 | 9.2:1 | 1.09 | 2.09 | 0.8662 | 17 | H | .0015 | - |
| 224-3408 | TC3408 | 6 | 3.9100 | 99.3 | 9.0:1 | 1.741 | 3.43 | 0.9842 | 1 | H | - | - |
| 224-3409 | 2243409 | 8 | 4.110 | 104.40 | varies | 2.132 | 3.619 | 1.3085 | - | - | .0055 | .850" from bottom |
| 224-3410 | TC3410 | 8 | 4.110 | 104.40 | - | 2.14 | 3.778 | 1.306 | - | - | .0067 | .850 up from bottom |
| 224-3411 | TC3411 | 6 | 3.5039 | 89.0 | 9.5:1 | 1.476 | 2.304 | 0.9054 | - | - | - | - |
| 224-3412 | TC3412 | 6 | 3.6220 | 92.0 | 9.5:1 | 1.47 | 2.462 | 0.9054 | - | - | - | - |
| 224-3413 | TC3413 | 8 | 3.552 | 90.2 | - | 1.216 | 2.036 | 0.866 | 3 | - | .0014 | .354 from bottom |
| 224-3414 | TC3414 | 8 | 3.552 | 90.2 | 9.0:1 | 1.223 | 2.048 | 0.864 | 3 | - | .0014 | .354 from bottom |
| - | TC3414A | 10 | 3.552 | 90.2 | 9.0:1 | 1.223 | 2.048 | 0.864 | 3 | - | .0014 | .354 from bottom |
| 224-3417 | TC3417 | 8 | 3.552 | 90.2 | - | 1.246 | 2.049 | 0.862 | 3 | - | .0014 | .354 from bottom |
| 224-3418 | TC3418 | 8 | 3.552 | 90.2 | - | 1.2215 | 2.04 | 0.863 | 3 | - | .0014 | .354 from bottom |
| - | TC3418A | 10 | 3.552 | 90.2 | - | 1.2215 | 2.04 | 0.863 | 3 | - | .0014 | .354 from bottom |

| <u>Rings</u> | <u>Notes</u> |
|------------------------------|---|
| 2-1.5mm, 1-3.00mm | 2.70" dia. Head recess .157" deep. Destroyed .020". SOHC. Press Fit pin. |
| 1-3/32, 2-5/64, 1-3/16 | .95" Dome with one valve relief. Except H5D. Not destroyed. Shallow Groove. |
| 2-5/64, 1-3/16 | Flat head. Model A. |
| 1-1.75mm, 1-2.00mm, 1-4.00mm | .170" Recessed head w/1 valve relief. Peugeot E82 eng. |
| 1-1.75mm, 1-2.00mm, 1-4.00mm | Flat Head. Volvo 2316cc |
| 2-1.50mm, 1-4.00mm | Recessed head 0.8mm deep. 7/1981-1984 Maxima 6 cyl. L24E eng. |
| 2-1.50mm, 1-4.00mm | Z22, Z22E 200SX, 720 engs. |
| 2-3/32, 1-3/16 | Head recess .234" deep. Trk. Engine. Low compression export piston. |
| 2-2.0mm, 1-4.00mm | Flat Head. For Brazilian Expot. |
| 2-5/64, 1-3/16 | 2.68" dia. Head recess by .091" deep. High comp. Land Rover & Triumph also. |
| 1-2.00mm, 1-2.5mm, 1-4.00mm | Crown .25" high & 2.30" dia. Head recess .20" deep. 22R engine., not destroyed |
| 1-1.20mm, 1-1.50mm, 1-2.80mm | Recessed Head w/2 valve reliefs. |
| 1-3.00mm, 1-2.00mm, 1-3.50mm | Recessed "Reentrant Bowl type" combustion bowl .67" deep. Powerstroke Direct Injection Turbo Diesel. Ni Resist Ring Carrier. |
| 2-5/64, 1-3/16 | 396 cid-Used in either left or right cylinder bank. .132" hi crown. Use Std. Oversize for .030 o/s 396 application. Not destroyed. 402 cid-Big Block 132" crown. Used in either left or right cyl. Bank. Not Destroyed. |
| 2-1.5mm, 1-4.0mm | 1976-1987 Non-Turbo. 1984-1987 EFI. 1984-1989 Turbo. F and W engs. 2.75" dia. Head recess .200" deep. Destroyed .010". |
| 1-2.0mm, 1-1.5mm, 1-4.0mm | 3.10" dia. Head recess .80" deep w/4 valve reliefs. LT. WT. For VIN W 1995-1998, 1996-1997 VIN X, & 1995-1996 VIN Z stamped AA. Destroyed .020". Shallow Groove. |
| 1-2.0mm, 1-1.5mm, 1-4.0mm | 3.10" dia. Head recess .80" deep w/4 valve reliefs. Destroyed .020". Shallow Groove. |
| 1-1.2mm, 1-1.5mm, 1-3.0mm | 3.10" dia. Head recess .295" deep. VIN L. Except Supercharged. Shallow Grove. |
| 2-5/64, 1-3/16 | 3.125" dia. "D" shaped recess .300" deep. VIN Y. Trk. Eng, EFI, Destroyed .010" |
| 2-1.5mm, 1-4.0mm | Flat Head, non-turbo w/carb. To 1-19-1989. |
| 2-2.0mm, 1-4.0mm | Chevy- S10 pickup with LR1 eng. 22mm pin. ISUZU-G200Z Eng. Trooper II & pickup. BOTH-Flat head. Use 1982 ring pack for all years. 22MM pin. |
| 2-5/64, 1-3/16 | Oblong head recess .072" deep w/2valve reliefs. EFI, VIN G. |
| 2-1.50mm, 1-3.00mm | VIN 4. Circular 2.94" dea. Head recess .200" deep. 19cc dish vol. |
| 1-3.00mm, 1-2.00mm, 1-3.50mm | Flat top w/6.7cc Ricardo Cup, Ni Risist ring carrier.Hard Anodized Crown. Factory Indirect Injection Turbo Diesel, Big Pin. |
| 2-5/64, 1-3/16 | Flat Top. |
| 1-5/64, 2-3/32, 1-1/4 | F6226 & F245 engines. Flat Head. |
| 2-1.50mm, 1-4.00mm | 22RTEC Turbo SOHC eng. 4-Runner & Pickup. 2.900" dia. Head recess .218" deep w/2 valve reliefs. |
| 2-1.50mm, 1-3.00mm | 3.100" Dia. Head recess .080" deep w/4 Valve Reliefs. VIN "W" & "Z" -262 CID. VIN "K" (L36) & "R" (L31) -350 CID. Shallow Groove. Not intended for Racing Applications. For use with ring set 41785 |
| 2-1.50mm, 1-3.00mm | 3.100" Dia. Head recess .080" deep w/4 Valve Reliefs. VIN "W" & "Z" -262 CID. VIN "K" & "R"-350 CID. Shallow Groove. Not intend ed for Racing Applications. For use with ring set 41786 |
| 1-3.00mm, 2-2.00MM, 1-4.00mm | Ricardo Bowl Head .148" Deep. Ni-Resist Ring Carrier. Reduced Compression Height by .010" to allow for block milling. |
| 2-1.50mm, 1-3.00mm | Oblong Head Recess .150" Deep. Use w/ Ring set# 41732 |
| 2-1.20mm, 1-3.00mm | 2.600" Dia. Head recess .015" deep. SOHC. VIN "C" & "N". |
| 2-1.50mm, 1-3.00mm | Flat Top. Coated Piston Skirt. Use w/ring set# 41855CP. |
| 1-1.20mm, 1-1.50mm, 1-2.00mm | 2.860" dia. Recessed Head, .05" Deep. V IN "K". Not intended for racing applications. Use w/ Ring Set# 41847CP. |
| 2-2.00mm, 1-4.00mm, | Flat Head. Shallow Groove. Use w/Ring set# 41708 |
| 1-3.00mm, 1-2.00mm, 1-3.50mm | Recessed "Reentrant Bowl type" combustion bowl .67" deep. Powerstroke Direct Injection Turbo Diesel. Ni Resist Ring Carrier. Same as 224-3163 except Reduced Compression distance by .010" to allow for deck milling. |
| 1-3.00mm, 1-2.00mm, 1-3.45mm | Recessed "Reentrant Bowl type" combustion bowl. Keystone Top Ring. 2nd Groove is a gas accumulator ring. Free Floating pin (comes with Lockrings). |
| 1-1.20mm, 1-1.50mm, 1-3.00mm | 2.825" dia. Head recess .258" deep. Coated Skirt. Shallow Groove. VIN "M" & "K". |
| 1-1.20mm, 1-1.50mm, 1-4.00mm | 3.140" dia. Head recess .270" deep. Coated Skirt. Vin "E", LA1 eng. |
| 2-1.50mm, 1-3.00mm | 2.931" Dia. Recessed Head X .193" deep. Shallow Top Groove .131". Coated Skirt. Use with ring set# 41546. |
| 2-1.50mm, 1-3.00mm | Recessed Head 2.701" dia. X .063" deep. Free Floating pin (comes with Lockrings). Coated Skirt. SOHC NPI. |
| 2-1.50mm, 1-3.00mm | Recessed Head 2.701" dia. X .063" deep. Free Floating pin (comes with Lockrings). Coated Skirt. SOHC NPI. |
| 2-1.50mm, 1-3.00mm | 2.642" dia. Recessed head X .162". Coated Skirt. Shallow Top Groove .131". Use w/ring set# 41546 |
| 2-1.500mm, 1-3.00mm | 2.951" Dia Recessed Head X .132" deep. Coated Skirt. Use with ring set# 41787 (8pk.). |
| 2-1.500mm, 1-3.00mm | 2.951" Dia Recessed Head X .132" deep. Coated Skirt. Use with ring set# 41788 (10pk.) |

